

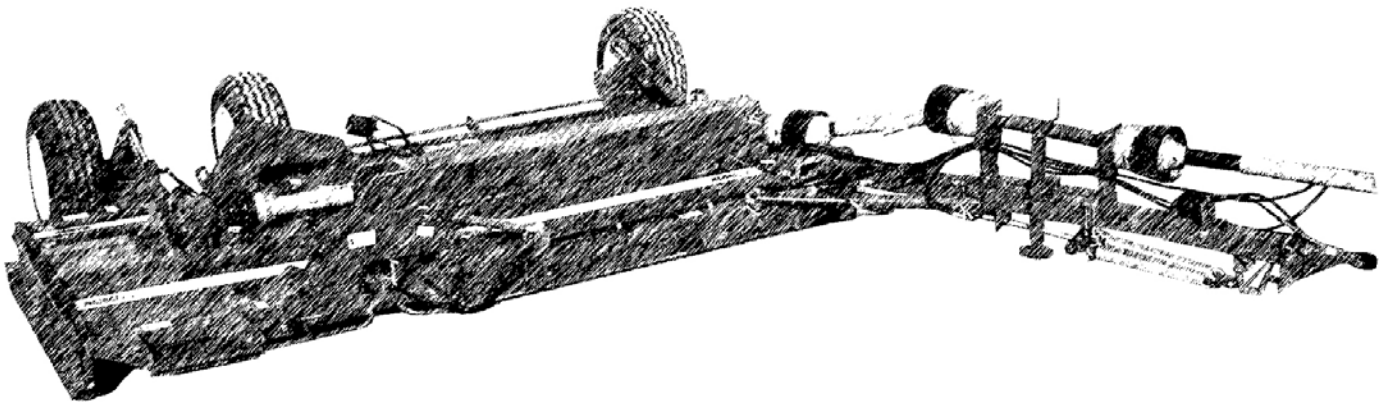

OPERATORS MANUAL & PARTS BOOK

TURF MAJOR 800T, 900T & 1200T



UK Office

Major Equipment Ltd.
Major Industrial Estate.
Walkers,
Middleton Rd.,
Heysham,
Lancs. LA3 3JJ

Tel.: 01524 - 850 501
Fax: 01524 - 850 502
E-mail ukinfo@major-equipment.com

Ireland Office

Major Equipment Ltd.
Ballyhaunis,
Co. Mayo,
Ireland

Tel.: 094 - 96 - 30572
Fax: 094 - 96 - 30788
E-mail info@major-equipment.com

Web: www.major-equipment.com

Write in Your Dealers Address & Tel. No. for your convenience.

Dealer

Address

.....

.....

.....

.....

Tel. No.

Disclaimer

While every effort has been made in the production of this manual to ensure that the information contained herein is full and correct, **Major** assumes no responsibility for errors or omissions.

Major reserves the right to modify the machinery and the technical data contained within the manual without prior notice.

Further to this, **Major** assumes no liability for any damages which may result from the use of the information contained within this manual.

Please return warranty card provided with this manual to register your Warranty and retain receipt as proof of purchase.

CONTENTS

SAFETY LABELS	3
INTRODUCTION	4
FOREWORD	4
WARRANTY	4
WORK STATION	5
KEY TO MAIN PARTS	5
GENERAL SAFETY REGULATIONS	7
REGULATIONS IN THE USE OF THE TRANSMISSION	7
PTO SHAFT LENGTH	8
STARTING REGULATIONS	9
HITCHING TO THE TRACTOR	9
TRANSPORT AND MOWING	10
MAINTENANCE	12
FOREWORD	12
INSPECTION BEFORE USE	12
MAINTENANCE SCHEDULE	13
BLADE ROTATION	14
SPECIFICATIONS	
PTO SHAFT MAINTAINENCE	15
PARTS BOOK	16
WARRANTY PROCEEDURE	30
TROUBLE SHOOTING	31

SAFETY LABELS

The Major Trailed Topper comes equipped with all safety labels in place. They are intended to help you operate your machine safely. Read and follow the safety label directions. Keep safety labels clean and legible. Replace damaged or missing safety labels.

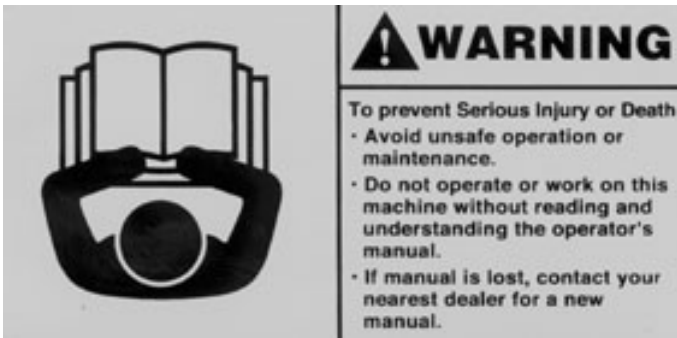

Thoroughly read and understand the manual.

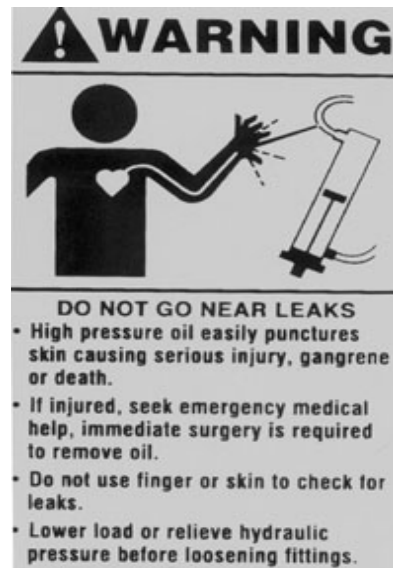

High Oil Pressure Hazard

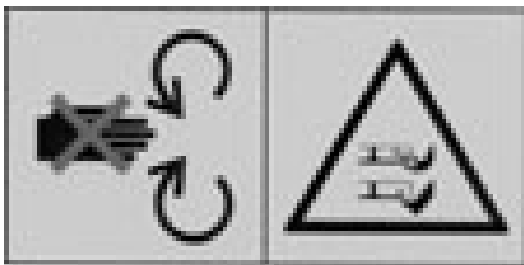

Rotating Blade Hazard - Keep clear from blades while machine is in operation.



Moving Parts Hazard - Keep clear while operating wings. (1200T MODEL)



Driveline Entanglement Hazard - Keep clear of PTO drives



Maintenance Warning – Keep wheel bearing bolts tight.

INTRODUCTION

The Major Trailed Topper that you have purchased is the result of costly development and extensive field-testing. It is an engineering product, backed by a dealer distribution network designed to offer you an efficient after sales service.

Please follow the instructions given in this manual. You will then obtain the best results from your new machine at the lowest cost.

IRELAND USERS

Health, Safety and Welfare at Work Act (1989).

UNITED KINGDOM USERS

Health and Safety at work Act (1974)

Both Acts require that all operators must be given instruction on the safe operation, maintenance and repair of all machinery. This booklet forms part of the instruction for the MAJOR TRAILED TOPPER and must be read by all operators and repairers before operating the machine. The supplier must also instruct the customer and user regarding the operation, adjustment and explain all necessary safety precautions

Lack of maintenance will induce excessive power consumption. This waste of power will not only induce a heavy load on the machine, but will also cause breakdowns and expensive repairs.

FOREWORD

An exact description of the machine model and year of manufacture will ensure quick and pertinent answers from our Technical Assistance Service. Always state the machine model when contacting our offices or your nearest dealer.

We suggest you write the data pertaining to your machine in the following space.

Year of manufacture		Model	
Serial Number		Date of purchase	

WARRANTY

The Major Trailed Topper is guaranteed for 1 season. No warranty is given where the machine is being used as a hire machine. Warranty is against faulty workmanship or parts, with the exception of components not of Major's manufacture or design, i.e. hydraulic components, Universally jointed shafts, blades and tyres, etc., which are subject to the original manufacturers conditions.

No warranty is considered unless the faulty parts have been returned. All replacement parts will be supplied on a chargeable basis until warranty has been accepted. Major cannot accept liability for injury or damage caused by our machines resulting from operational negligence.

Major reserve the right to withdraw warranty if:

- Non-original parts have been fitted.
- The machine is not maintained correctly
- The machine is overloaded, or operated incorrectly
- The machine is used for purposes other than those for which it has been designed

Major and importers do not accept liability if non-Major parts have been fitted. Please read warranty procedure on page .

WORK STATION

The operator must remain seated while working the machine. Always ensure that the PTO has been turned off and the parking brake applied before leaving the tractor cab.
 The operator must always apply parking brake, and turn off engine before leaving machine or carrying out maintenance.



CAUTION

Never operate tractor hydraulics' with the tractor switched off

Never allow hydraulic hoses inside the tractor cab

KEY TO MAIN PARTS

1200T

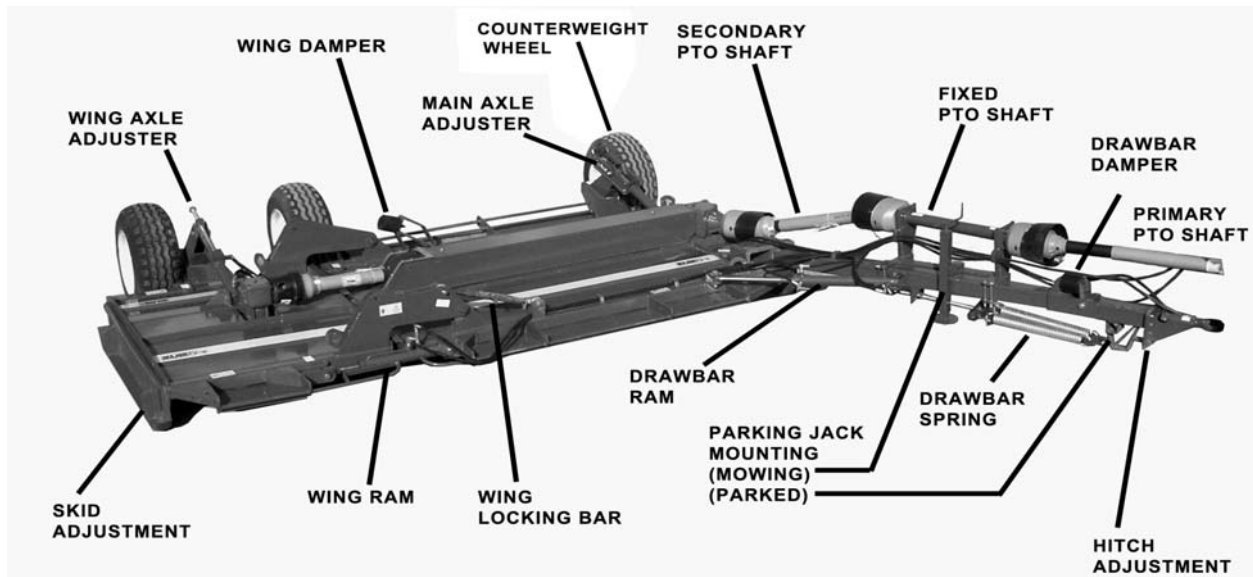

800T & 900T

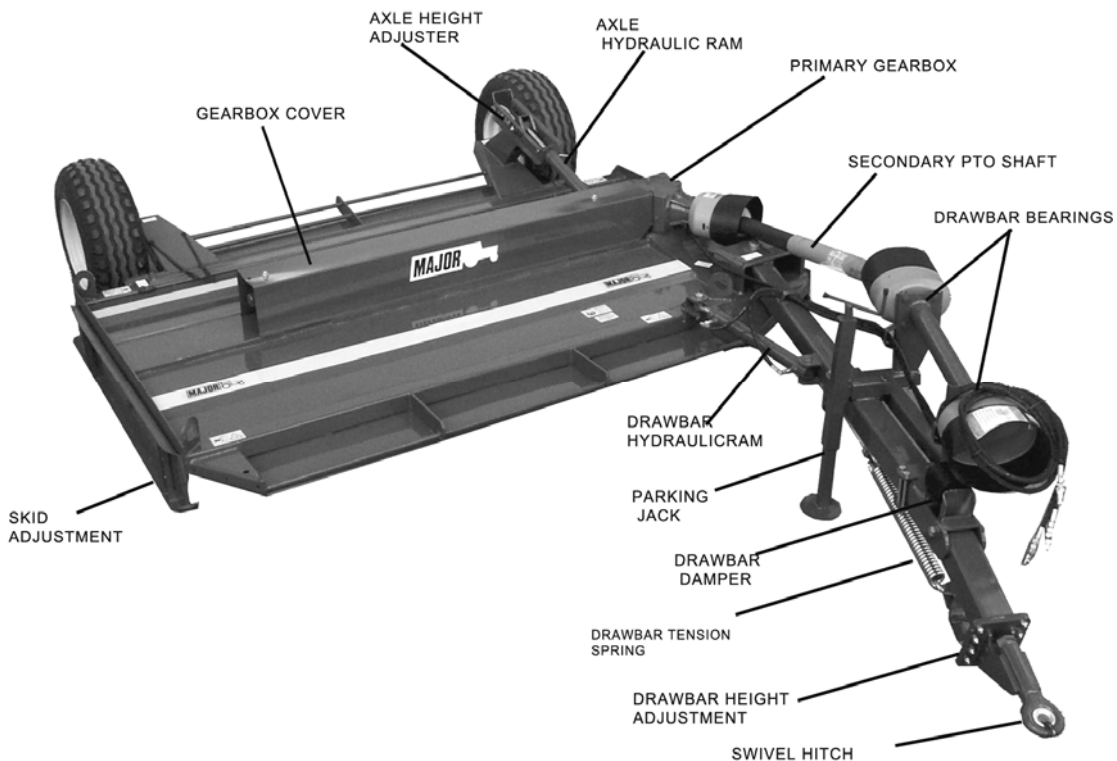

MACHINE SET-UP

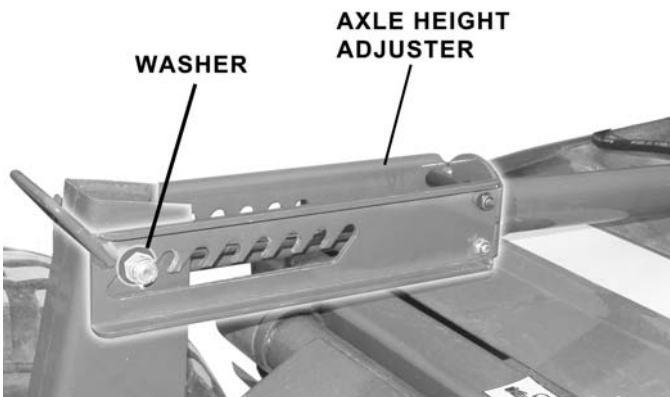
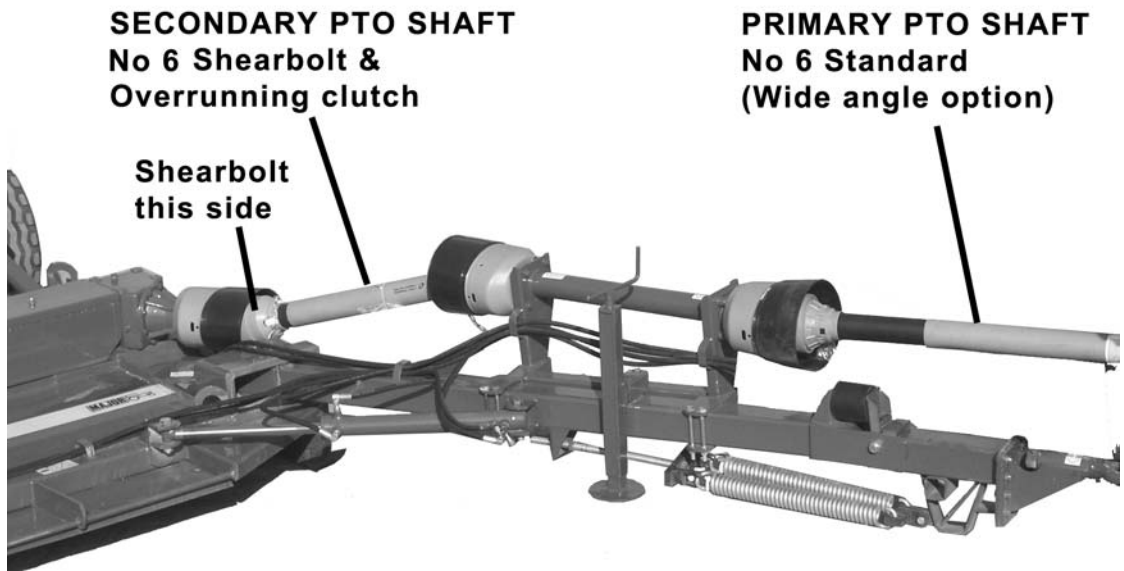
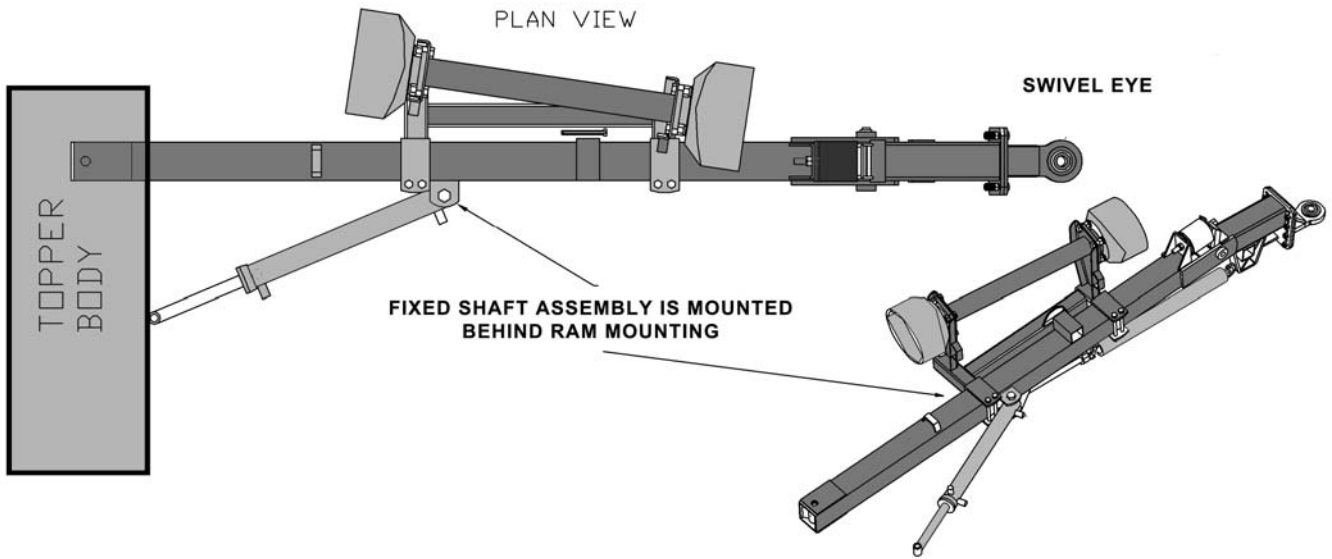

AXLE STOPPER SETUP

GENERAL SAFETY REGULATIONS

The Major TRAILED TOPPER must only be used for cutting grass. Moreover, it must only be used with a suitable tractor (see specifications on page 20) and driven by an adequate drive-line by the tractor PTO

All other use is strictly prohibited.

Users should become thoroughly familiar with the contents of this manual before using, servicing and mounting the implement to the tractor and all other pertinent operations.

Never wear jewellery, loose clothing such as ties, scarves, belts, unbuttoned jackets or dungarees with open zips which could become caught up in moving parts. Always wear approved garments complying with accident prevention provisions such as non-slip shoes, ear muffs, goggles and gauntlets. Wear a jacket with reflecting stickers if the implement is used near public highways.

Consult your retailer, the Labour Health Service or your nearest equivalent authority for information about the current safety provisions and specific regulations to comply with in order to ensure personal safety



CAUTION

Ensure the PTO does not bottom when turning, or when tractor front axle is raised or lowered while climbing or descending a sharp incline.

REGUALTIONS FOR THE USE OF THE TRANSMISSION



WARNING

Unless it is correctly protected, the transmission could cause death since it can catch on parts of the body or clothing

The transmission to the gearboxes is protected throughout the machine by both guarded PTO shafts and bolt down covers. All guarding should be kept efficient and in good condition. If the condition is poor, the guarding should be renewed before the implement is used

Ensure retaining chains are correctly anchored on all PTO shafts, preventing them from turning. Ensure drive-line can turn easily within the shield.

Keep spline grooves clean and greased so that PTO shaft can connect easily. Besides being described in this manual, the method by which the PTO shaft is connected to the tractor must be checked out with the instructions in the tractor manufacturer's manual.



IMPORTANT

The correct rotational speed of the tractor PTO input is 540 rpm.

PTO SHAFT LENGTH

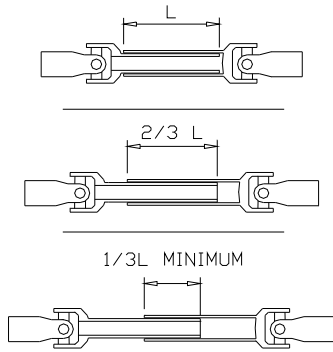

The tractor PTO shaft length may be altered to suit the individual tractor model.

When the machine is in operation, the PTO shaft should have a minimum 1/3 engagement as shown in the diagrams across

After the TRAILED TOPPER has been hitched to the tractor, it should be checked in various positions that the drive line is the correct length. If the PTO is too short and tends to slip out of place, it must be replaced with a longer one.

CAUTION



Contact your nearest dealer or a specialised retail outlet if the PTO must be replaced with a longer one, since this must belong to the same power category and possess the same characteristics.

An unsuitable PTO could easily break

If the PTO shaft is too long, it should be shortened in the following way:

- Set the machine at a minimum distance from the tractor, then brake the tractor and switch off the engine.
- Separate the two halves of the PTO. Insert the female part into the tractor PTO and the male part into the TRAILED TOPPER PTO, checking that the position is correct by means of the fixing pins.
- Lay the two halves of the PTO together, keeping them parallel.

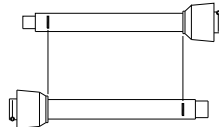

- Using a felt tip pen, match mark the place where the two halves must be shortened as shown.
- First cut shield "1" and use part "2" as a reference to cut the splined shaft.
- Proceed in the same way for the second half.

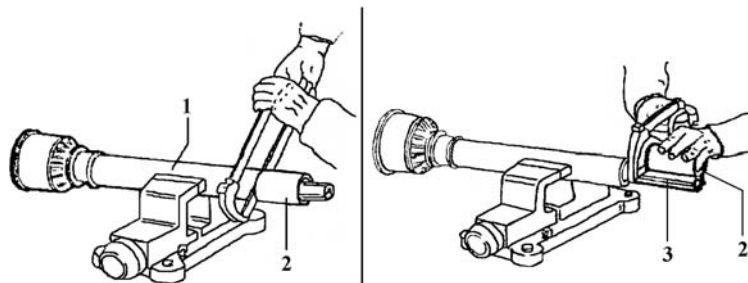

- Trim and chamfer the two cut ends of the PTO and clean off all swarf and shavings. Grease the two profiles and join the two halves of the PTO together again. Mount the PTO shaft and check that its length is correct as before. The shaft must not reach the end of the tube or project from this.

STARTING REGULATIONS

Always check that any imminently dangerous conditions have been eliminated before using the machine. Ensure all guarding is present & the operator is fully aware of the operations of the machine

WARNING



Always ensure the PTO shaft yoke ends are locked onto the splined shafts on both the tractor and the implement. An unlocked shaft could slip out of position, causing notable mechanical damage and serious injury to both operator and bystanders.

HITCHING TO THE TRACTOR

- Reverse the tractor, connect the hitch & secure in position with correct size drawbar pin.
- Ensure the tractor parking brake is applied.
- Adjust the hitch eye to suit the tractor drawbar height, paying particular attention to keep the bolts on the adjuster plate as spread as far as possible.
- Connect the machine to the tractor, The drawbar spring adjuster should now be tensioned ensuring the front of the skids are raised approx 25mm (1") higher than the rear.
- Before connecting the PTO shaft to the tractor, check for length as previously described in this manual.
- Ensure PTO check chains are anchored to prevent PTO guarding from rotating.
- Connect the hydraulic hoses to the appropriate connection.

CUTTING HEIGHT

- Adjust the skids by lifting the machine and removing the four skid retaining bolts & relocating the skid to the desired height.
- The axle stop should now be adjusted, it should be set to that the wheels are taking as much weight as possible while the skids are maintaining ground contact.

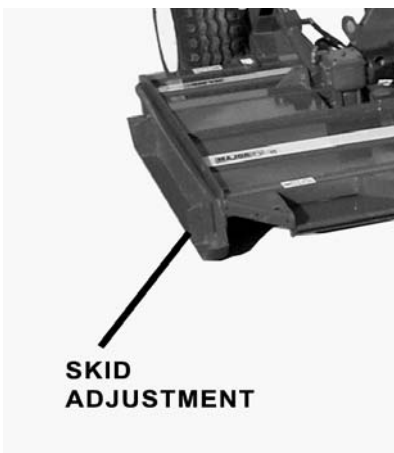

TRANSPORT & MOVING

Check the local Highway Code regulations before driving the tractor on public highways with a towed implement. Check the reflectors, hazard flashers and/or projecting load indicators are installed when required and efficient. These indicators must be installed correctly and easily seen by the drivers of other vehicles.



WARNING

Bystanders must not be allowed to lean against or climb onto the machine during transport or while working. Do not allow bystanders to ride on the machine.

TRANSPORT POSITION

- Check machine is hitched to the tractor as described. Ensure the tractor parking brake is applied
- Lift the body clear from the ground by activating the axle hydraulic ram
- Transform the machine into transport position by hydraulic control. The Drawbar ram should be full closed. On the 1200T model, continue to hold the spool in this position & the wing will lift up into a vertical position.
- Lock the wing into transport position & retain pin with clip (1200T model only)
- Adjust the axle height stopper to the highest position.
- Operate the tractor hydraulics to pull in the wing ram

1200T TRANSPORT LOCKING BAR LOCATIONS

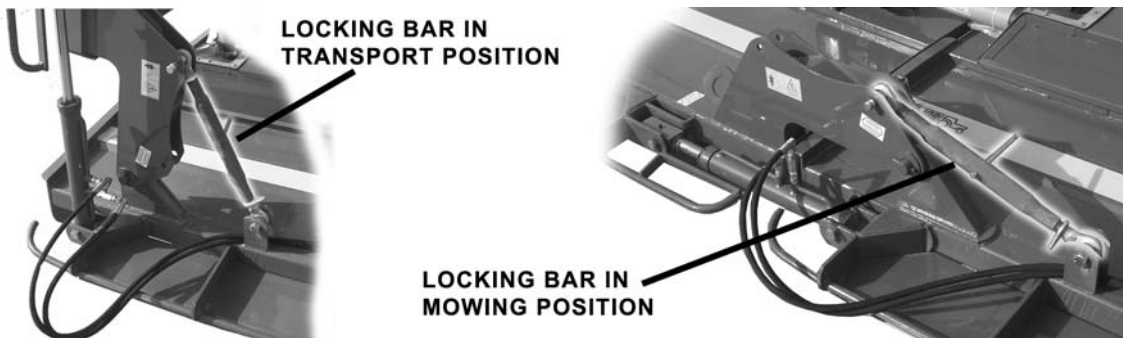

WARNING

Maximum transport speed for the implement is 30km/h.

MOWING POSITION

- Check machine is hitched to the tractor as described. Ensure the tractor parking brake is applied
- Ensure the body is clear from the ground by activating the axle hydraulic ram.
- Transform the machine into mowing position by hydraulic control.
- 800T and 900T models sequence: The drawbar ram will push out the cutting deck fully into operating position.
- 1200T model sequence: The wing will drop first fully to the ground. Continue to hold the spool in position and the drawbar ram will push out the body into mowing position.
- Lock the wing into mowing position & retain pin with clip (1200T only).
- Adjust the axle height stopper to the desired position. On the 1200T model adjust the threaded bar to equalise the machine.
- Operate the tractor hydraulics on the axle spool to lower the body against the axle stops.

MOWING



WARNING

Never place limbs under the machine while rotors are turning.
Rotors can remain turning for up to 1 minute after disengaging PTO



IMPORTANT

Ensure drawbar ram is fully extended before operating PTO.

- The MAJOR Trailed Topper is designed to operate at a max 540 rpm. Always operate on level ground when hitching / unhitching the implement. This will prevent dangerous movement.
- **Never allow anyone to stand between the tractor and the TRAILED TOPPER** Ensure the machine is hitched correctly to the tractor as previously described
- Ensure cutting decks are lowered to the ground.
- Start up the tractor PTO at a low RPM.
- Build up to operating speed, select a suitable forward gear & proceed to cut grass.

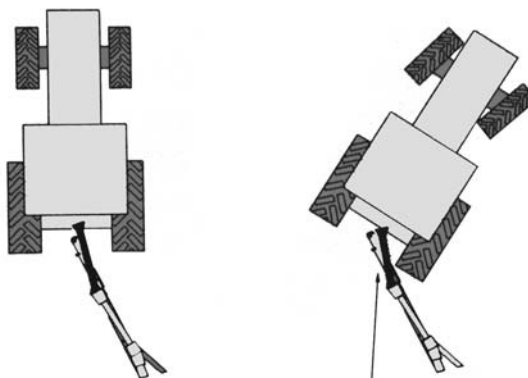

ENSURE PTO DOES NOT FOUL
WHEN TURNING SHARPLY

MAINTENANCE

 **IMPORTANT**
Maintenance must be carried out by qualified personnel

The TRAILED TOPPER must always be disconnected from the tractor before any cleaning, lubricating and servicing operations can be carried out. If emergency operations are required whilst the machine is connected to the tractor, switch off the engine, engage the parking brake and disengage the PTO. Good, regular maintenance and correct use are essential if the TRAILED TOPPER is to remain safe and long lasting.

INSPECTIONS BEFORE USE

 **WARNING**
Always disengage PTO, Switch off tractor engine and engage the parking brake before making adjustment to the machine

1. With the wing lowered (1200T) and the whole machine as level as possible, check the oil level in the Primary Gearbox, top up as required with SAE EP90 gear oil through the oil filler plug indicated. The correct level is at the oil level plug indicated. Check the oil level in the Rotor Gearboxes and top up as required with SAE EP 90 gear oil through the oil filler plugs indicated. The correct level is at the oil level plug indicated.

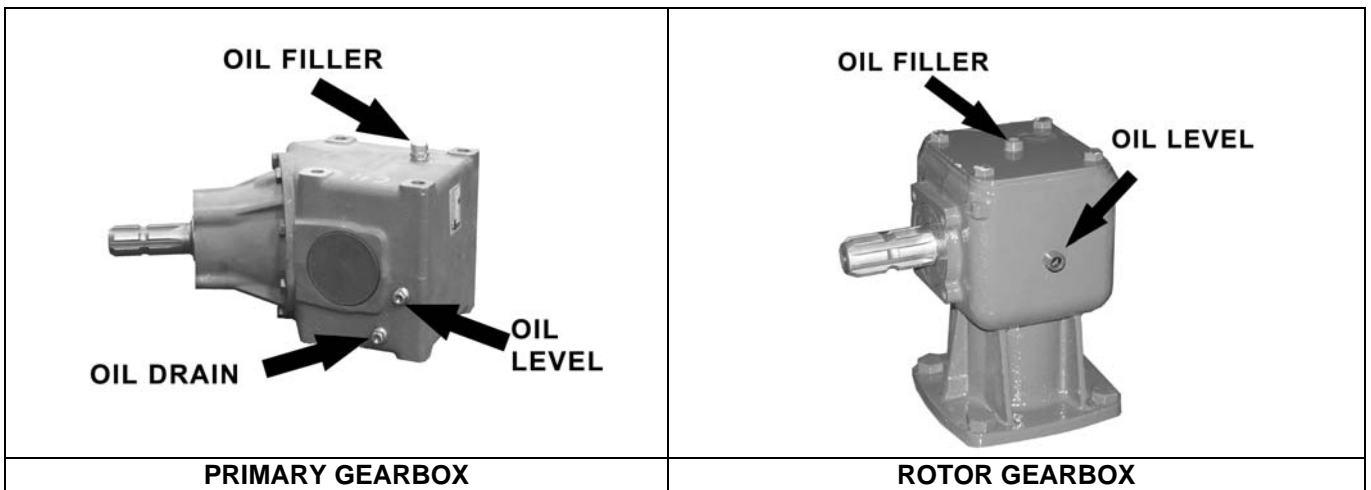

2. Grease the PTO shaft universal joints, drive shaft bearing and axle bushings daily.
3. Grease the drawbar pivot bush daily.
4. Re-sharpen old blades with a grindstone if necessary. Replace bent blades with new ones.
5. Check the blade mounting bolts are tight.
6. Ensure the gearbox shaft nuts are tight and retained in place by split pin.
7. Check tightness of all nuts, bolts and retaining screws after the first and second hours of work.
8. Ensure safety guards and flaps are in place at all times where fitted.
9. Due to the corrosive nature of grass when cut, wash down the machine when finished mowing, especially when the machine is being stored for a long period of time.

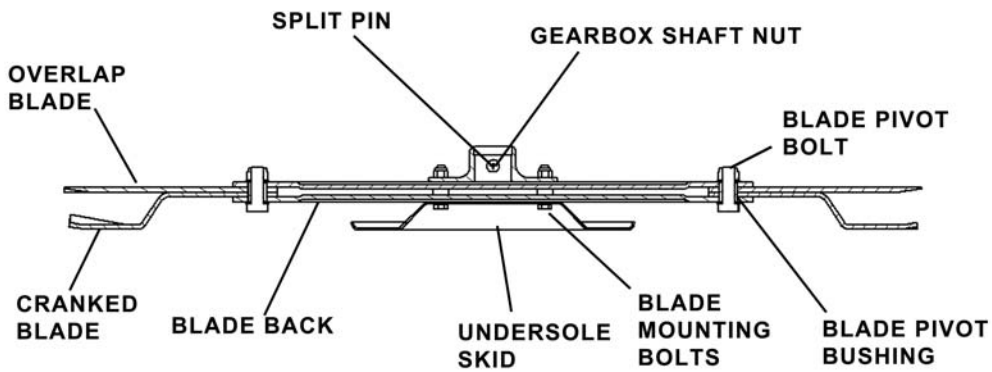

MAINTENANCE SCHEDULE

Grease the following:

	Initially	8 Hours
1 PTO Shaft yoke ends (8)	<input type="checkbox"/>	<input type="checkbox"/>
2 Drawbar drive Bearings (12)	<input type="checkbox"/>	<input type="checkbox"/>
3 Drawbar pivot (1)	<input type="checkbox"/>	<input type="checkbox"/>
4 Axle Pivot (2)	<input type="checkbox"/>	<input type="checkbox"/>
1200T only		
5 Wing Pivots (2)	<input type="checkbox"/>	<input type="checkbox"/>
6 Wing Axle (2)	<input type="checkbox"/>	<input type="checkbox"/>

All nuts and bolts in the transmission including Rubber Couplings, Star Drives, PTO Shafts, Gearboxes & wheel nuts should be checked for tightness after mowing at the following intervals:

- 1st 50 acres,
- 1st 100 acres
- 1st 250 acres,
- And every 250 acres thereafter. Lubricate moveable mechanical joints when required.



IMPORTANT

Ensure blade rotation and timing is correct after servicing transmission

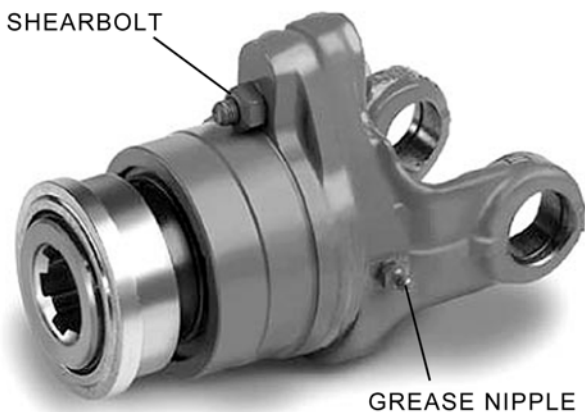

SHEAR BOLT REPLACEMENT

Slide yoke shield back.
Drive out sheared bolt with hammer and punch.
Align holes and install new shear bolt.

Use only genuine MAJOR replacement shear bolts.
M10X60 BZP -8.8

Slide yoke shield securely in place

IMPORTANT

Fit PTO shaft with the shearbolt end connected to the
Tonner as directed on the PTO guarding

BLADE ROTATION

Blades must always be timed at 90° to each other. Failure to do so can cause the blades to foul & in turn may damage the transmission.

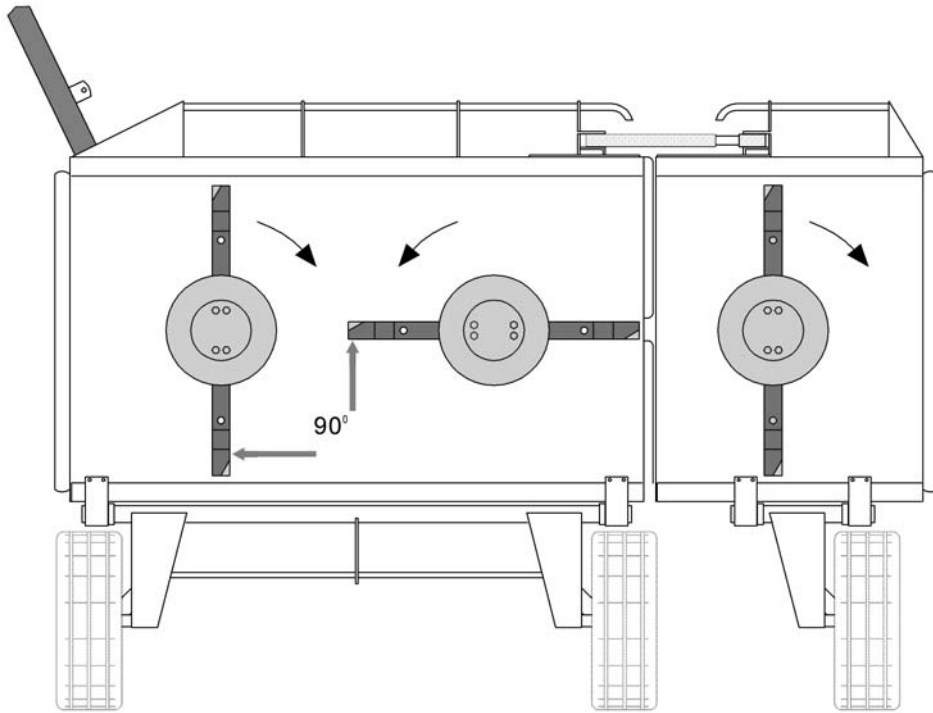

MAJOR 1200T BLADE ROTATION – PLAN VIEW

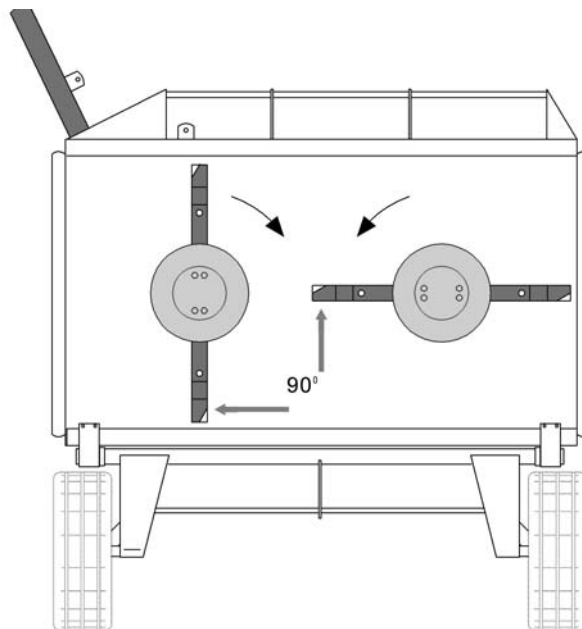

MAJOR 800T & 900T BLADE ROTATION – PLAN VIEW

SPECIFICATIONS

SPECIFICATIONS	800 T	900 T	1200 T
Transport Width	2538	2943	2641
Overall Width	2538	2943	3760
Cutting Width	2399	2694	3569
Cutting Range	12-205	12-205	12-205
No. of Blades	8	8	12
Blade Tip Speed	13685	15298	13685
Power Requirements	35-60	35-60	40-90
Tyre Pressure	2 BAR	2 bar	2 bar
Gearbox oil	EP 90	EP 90	EP 90
Weight	550 kg	650 kg	1100 kg

PTO SHAFT MAINTAINANCE

Guard Removal & Yoke End Greasing.

1. Prise back locking tabs
2. Pull back PTO Guard
3. Grease points as shown
4. Push Guard into position
5. Click into place
6. Tie check chain

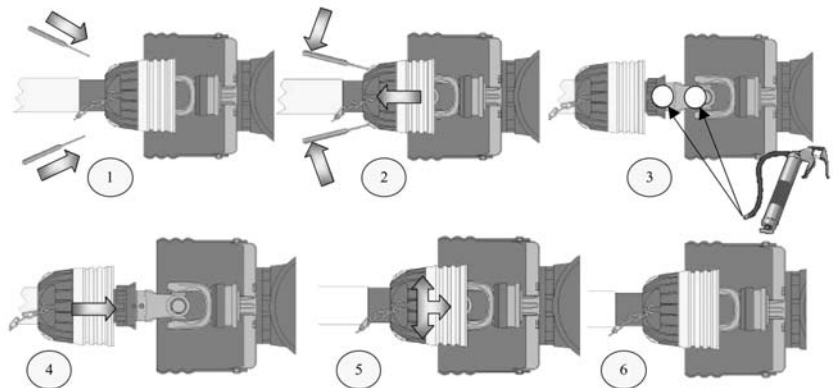

PTO GUARD GREASING INTERVALS

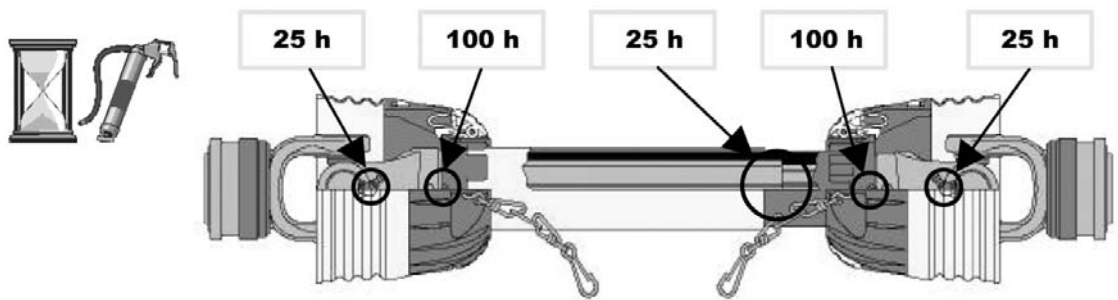

PARTS LISTING

Use only **MAJOR** spare parts for the best results.



SAFETY FIRST!

A moment's lack of attention can result in an accident, as can failure to observe certain elementary precautions. Do take time to ensure your safety and others are not put at risk.

Essential Do's and Don'ts.

Don't allow any spilt oil or grease to remain on the floor - wipe it up straight away, before someone slips on it.

Don't use ill-fitting spanners or other tools, which may slip and cause injury.

Don't attempt to lift a heavy component, which may be beyond your capacity - get assistance.

Don't rush finish a job, or risks by taking shortcuts.

Do wear eye protection when using power tools such as drills, grinders, etc.

Do keep loose clothing (cuffs, tie, etc.) and long hair well out of the way of moving mechanical parts. If possible wear overalls.

Do remove rings, wristwatches etc. before working on a machine.

Do keep your work area tidy - it is only too easy to fall over articles left lying around.

Do ensure that any lifting tackle that has a safe working load rating adequate for the job.

Do carry out work in a logical sequence and check that everything is correctly assembled and tightened afterwards.

Do ensure that all guarding is fitted after servicing the machine.

Do remember that your machines safety affects that of yourself and others.

If in doubt contact your local **MAJOR** dealer.

TRAILED TOPPER DRAWBAR

Item	Part No.	Description	Qty
1	8SM11-4	PTO Guard (Oval)	2
2	SF1-12	Flange Bearing	2
3	8T3-1	Dummy Shaft (Drawbar)	1
4	58X3FBZP	Bolt	8
5	58FN	Nyloc Nut	16
6	FWM16	Flat Washer	16
7	8SM9-3	Spacer	8
8	M16	Nyloc Nut	1
9	8T19	Spacer Plate	2
10	MOT10	BUFFER	1
11	M20	M20 Nyloc Nut	2
12	8T-AD1	Drawbar Hinge	1
13	8T-AD2	Drawbar Toe	1
14	M12X35BZP	Bolt	8
15	M12NN	Nyloc Nut	12
16	M20X150B	Bolt	1
17	12T-SPR	Drawbar Spring	1
18	8T15	Spring Tensioner	1
19	M20HEX	Nut Plain	2
20	S-272	Lock Pin	1
21	P575	Topper Jack	1
22	12TWTDRAM	Drawbar Ram (1200T Model)	1
22	GRAS10/1	Hydraulic Ram (800T & 900T Model)	1
23	M20X120BZP	Bolt	1
24	8T3	Drawbar	1
25	M12X150BZP	Bolt	4
26	9T3/1	Dummy shaft bolt-on mounting.	1
27	1X8FBZP	Pivot Bolt	1
28	V60WA 1100	Tractor primary PTO Shaft 1200 Model	1
28	V60 -1100	Tractor primary PTO Shaft 800 & 900 Model	1
29	RTE01	Rotary Toe Eye	1
30	12TWTDSM	Double Spring Mount	1
31	M12X50BZP	Bolt	1
32	12TWT DST	1200 Trailed Topper Spring Tensioner	1
33	12TSTDTB	Drawbar Double Spring Adjuster	1
34	12TWTDSGA	Double Spring Assembly	

TRAILED TOPPER AXLE

Drawing No	Part No	Description	Qty
35	M12x120 BZP	Bolt And Nyloc Nut	4
36	8T12	Axle Clamp	5
37	M20x110 BZP	Bolt And Nyloc Nut	1
38	9TGTA-1	Axle (12T Model & 900T Model)	1
38	8T7	Axle (800T Model)	
39	105x 153 W1	Wheel 800T Model	2
39		Wheel 900T Model	2
39		Wheel 1200 T Model	3
40	S2220	Wheel Nut	8
41	9TGTA-R1	Axle Ram 12T Wing & (Older models).	1
42	9TGTA-R1N	Axle Ram New Type	1
43	9TGTA-TB	Axle Ram Stop	1
44	9TGT-AP1	Ratchet Height Adjuster	1
45	8SM9/4	Bush	1

800T & 900T GEAR DRIVEN TRAILED

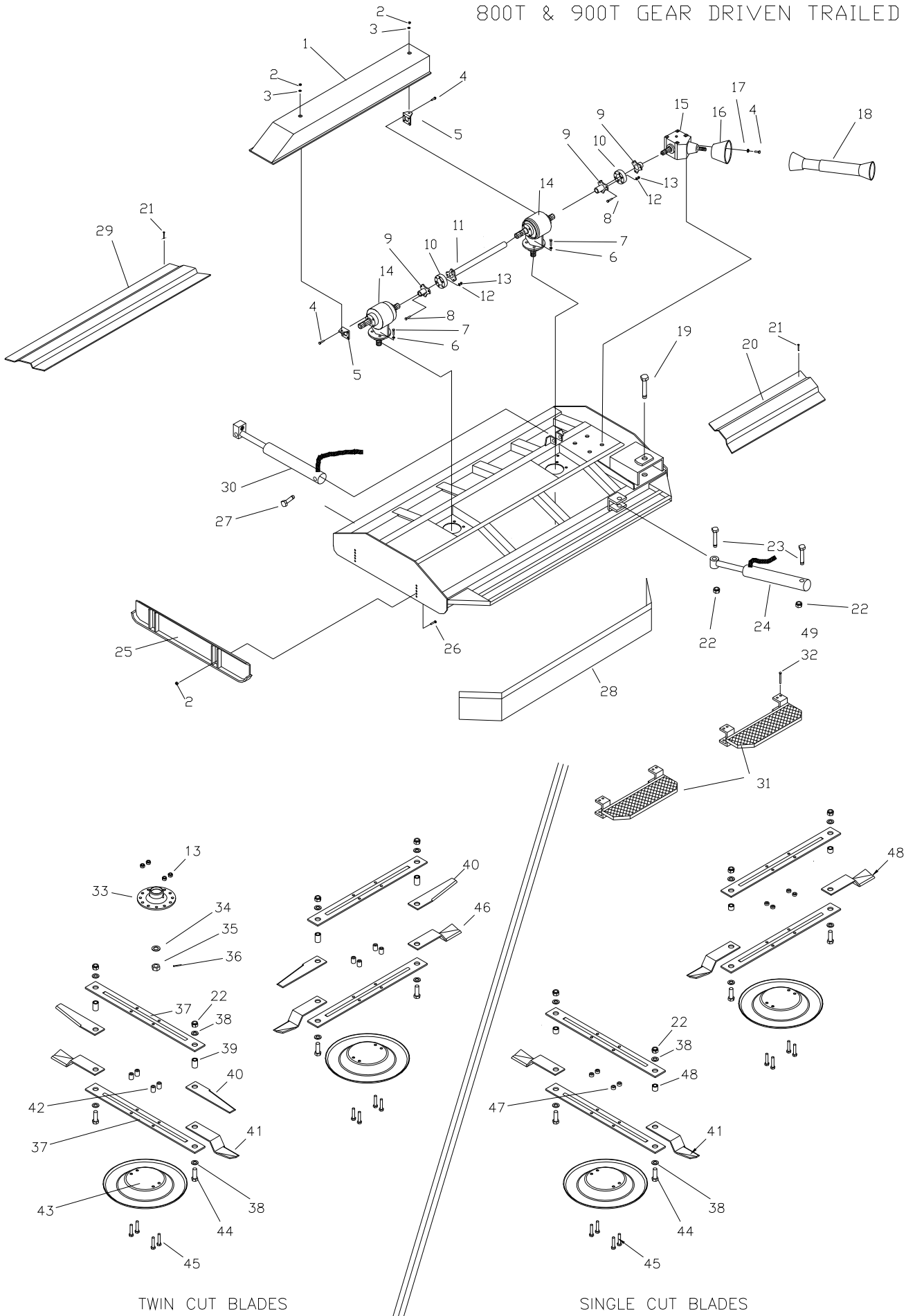

TWIN CUT BLADES

SINGLE CUT BLADES

800 & 900 TRAILED BODY

Item	Part No.	Description	Qty
1	9TGT-TC	Cover	1
2	M12	Nyloc Nut	4
3	FWM12	Flat Washer	16
4	M8 x 16 SZP	Bolt	12
5	9TGTC-CB	Cover Bracket	2
6	SW58	Spring Washer	2
7	5/8 x 2 FBZP	Bolt	8
8	12 x 3 FBZP	Bolt	12
9	8SM18	Short Star Drive	3
10	NT55A	Rubber Coupling	2
11	9TGT-DT	Drive Tube 900T model	1
	8TGT-DT	Drive Tube 800T model	
12	SW12	Spring Washer	12
13	1/2 F	Nyloc Nut	12
14	LF205T21	Secondary Gearbox	2
14	LF135T21	Secondary Gearbox (pre 2003)	2
15	T291A	Primary Gearbox	1
16	NT20-AA	PTO Guard extended	1
17	M8FW	Flat Washer	4
18	T60BOOR1100	Secondary PTO Shaft	1
19	1 X 8 FBZP	Pivot Bolt	1
20	9TGTC-2	Front Corrugated Cover	1
21	NT14C	Tech Screw	23
22	M20	Nyloc Nut	2
23	M20 x 120 BZP	Bolt	4
24	GRAS10	Hydraulic Ram	1
25	SLHO2AS	Skid	2
26	M12 x 35 BZP	Bolt	8
27	M20x110BZP	Bolt	1
28	9T-SKF	Safety Skirt	1
29	9TGTC-1	Rear Corrugated Cover	
30	9TGTA-R1N	Axle Ram New Type	1
31	9TGTG-1	Safety Guard (Front) (pre 1997)	2
32	M10 x 110 BZP	Bolt for Safety Guard	6
33	DF-BMP	Blade back mount	1
34	LF135-2	Gearbox Washer	2
35	LF135-1	Gearbox Nut	2
36	GBPINS	Gearbox split pin	2
37	8SM9-2	Blade back	2
38	FWM20	M20 flat washer	4
39	12T-LBB	Overlap Blade bushing	4
40	NTSC12C	Overlap Blade 900T model	4
	12T-OLB	Overlap Blade 800T model	
41	9GTB-A	Swing blade 900T model (anti-clock)	2
	NTAB10A	Swing Blade 800T model (anti-clock)	
42	12T-BBS	Overlap Blade back spacer	8
43	9GT-USS	Under sole skid	2
44	M20X60BZP	Bolt	4
45	12X212FBZP	Bolt	8
46	9GTB/C	Swing blade 900T model (clock)	2
	8SM9-1	Swing Blade 800T model (clock)	
47	8SM9-3	Blade back spacer	8
48	8SM9-4	Blade bushing (std)	4

1200 TRAILED BODY & WING

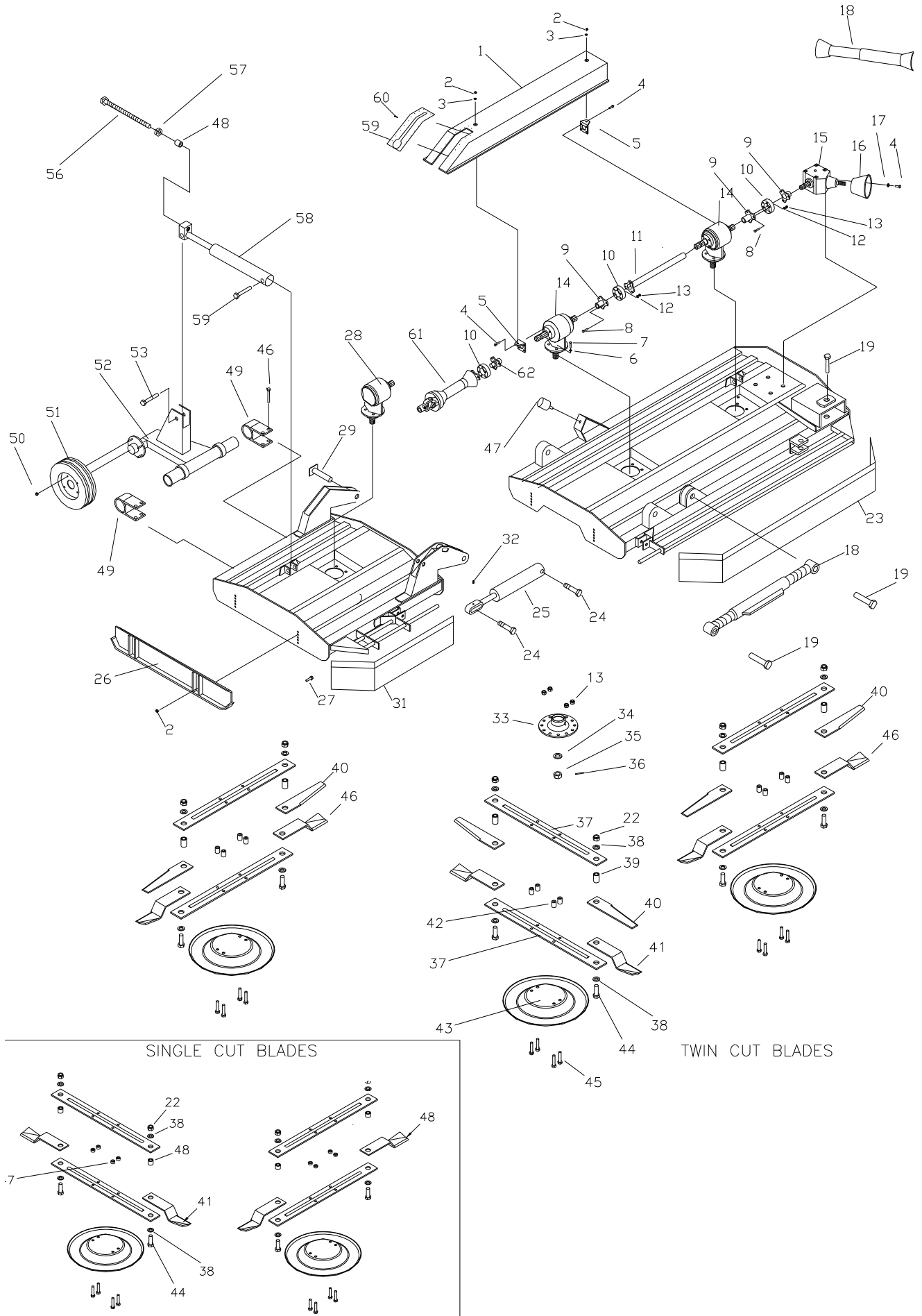

1200 TRAILED BODY & WING

Item	Part No.	Description	Qty
1	127GT-TC	Cover	1
2	M12	Nyloc Nut	4
3	FWM12	Flat Washer	16
4	M8 x 16 SZP	Bolt	12
5	9TGTC-CB	Cover Bracket	2
6	SW58	Spring Washer	2
7	5/8 x 2 FBZP	Bolt	8
8	12 x 3 FBZP	Bolt	12
9	8SM18	Short Star Drive	3
10	NT55A	Rubber Coupling	2
11	8TGT-DT	Drive Tube	1
12	SW12	Spring Washer	12
13	1/2 F	Nyloc Nut	12
14	LF205T-21	Secondary Gearbox	2
14	LF135T-21	Secondary Gearbox (pre 2003)	2
15	T291A	Primary Gearbox	1
16	NT20EX	PTO Guard extended	1
17	M8FW	Flat Washer	4
18	T60 SBOR1100	Secondary PTO Shaft	1
19	1 X 8 FBZP	Pivot Bolt	1
20	ATL1	Floatation restrictor	1
21	S74	Pin	23
22	M20	Nyloc Nut	2
23	8SM30	Safety Skirt	4
24	M20x110BZP	Bolt	1
25	17GMWR4	Ram	1
26	SLHO2AS	Skid	2
27	M12X35BZP	Bolts	8
28	LF205	'L' Wing Gearbox	1
-	LF135	'L' Wing Gearbox - pre 2003	
29	12GMPIN	Pivot Pin	
30	9TGTA-R1N	Axle Ram New Type	1
31	9T-SKR	Wing Skirt	1
32	849	Grease Nipple	
33	DF-BMP	Blade Back mount	1
34	LF135-2	Gearbox Washer	2
35	LF135-1	Gearbox Nut	2
36	GBPINS	Gearbox split pin	2
37	8SM9/2	Blade Back	2
38	FWM20	M20 flat washer	4
39	12T-LBB	Overlap Blade bushing	4
40	12T-OLB	Overlap Blade	6
41	NTAB10A	Swing Blade (anti-clock)	2
42	12T-BBS	Overlap Blade back spacer	8
43	9GT-USS	Under sole skid	2
44	M20X60BZP	Bolt	4
45	12X212FBZP	Bolt	8
46	NTSB10A	Swing Blade (clock)	2
47	8SM9-3	Blade back spacer	8
48	8SM9-4	Blade bushing (std)	4
49	8T12	Axle clamp	4
50	S2220	Wheel Nut	-
51		Wheel - state model	
52	12TGTA-1	Wing Axle	1
53	M20X100BZP	Bolt c/w Nyloc Nut	1

1200 TRAILED BODY & WING

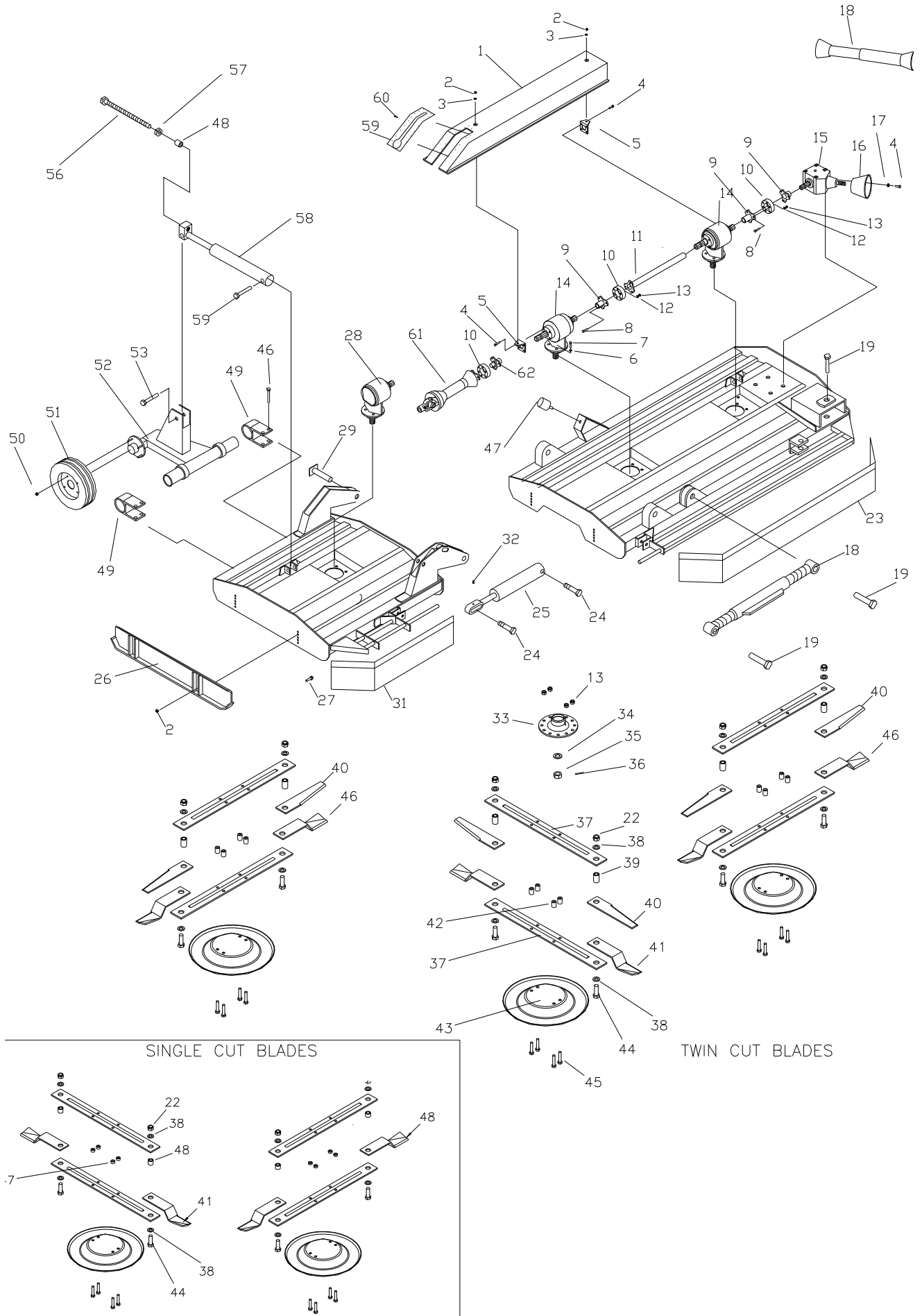

1200 TRAILED BODY & WING

Item	Part No.	Description	Qty
54	9TGTA-R	Axle Ram	1
55	M20X110BZP	Bolt c/w Nyloc Nut	1
56	9TGTA-TB	Axle Height stop	1
57	M20HEX	Plain Nut	1
58	M12x120 BZP	Bolt And Nyloc Nut	4
59	12GMTC1	Rubber Cover	1
60	NT14C	Tech Screw	1
61	12TW-PTO	Wing Drive PTO Shaft	1
62	EW45/2	Wing PTO Stub Star Drive (21 spline)	1

TRAILED TOPPER HYDRAULIC CIRCUIT

1200T HYDRAULIC DIAGRAM

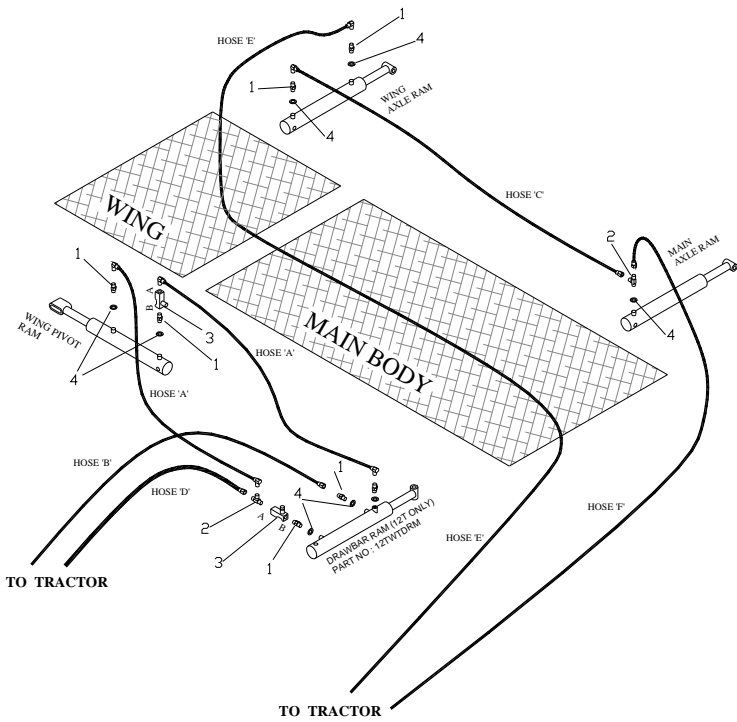

800T & 900T HYDRAULIC DIAGRAM

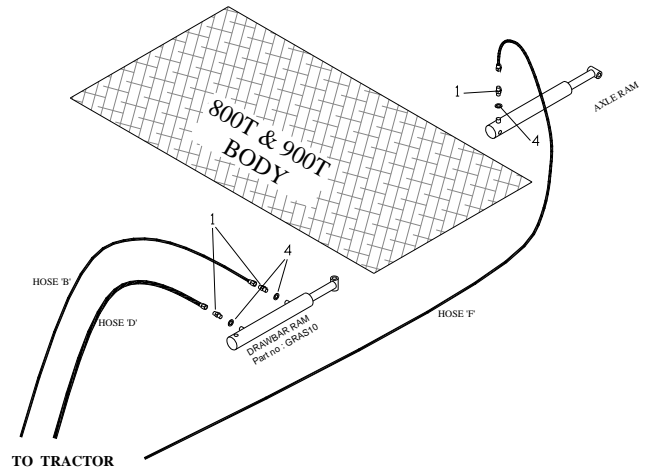

Item	Part No.	Description	Qty
1	EMM14	1/4" Male/male connector	
2	EMMMT-14	'T' Block	
3	DRV08	Flow restrictor	
4	EDOW14	Dowty washer	

PRIMARY GEARBOX

DESIGNATION		GEAR BOX		T-291A		CODE N°	9.291.005.00
POS.	DRG. N.	PIEC	DESCRIPTION				
1	0.291.3001.00	1	SHAFT	1"3/8			
2	8.7.3.00331	1	OIL SEAL	45X85X10			
3	8.5.2.00332	1	SNAP RING	85 UNI7437			
4	0.709.7500.00	1	SHIM	84.7			
5	8.0.9.01186	2	BEARING	30209			
6	8.4.7.01111	1	COTTER PIN	B4X55			
7	0.291.0301.00	1	CASING	T3			
8	0.286.5001.00	1	CROWN WHEEL	Z23 M5.41			
9	8.0.9.00129	1	BEARING	30307			
10	0.267.7500.00	1	SHIM	79.9			
11	8.6.5.00006	3	PLUG	3/8"GAS			
12	8.5.2.00030	1	SNAP RING	80 UNI7437			
13	8.7.0.00790	1	CAP	80X10			
14	0.132.7106.00	1	NUT	M30X1.5			
15	0.244.7500.00	1	SHIM	51.5			
16	8.0.9.00128	1	BEARING	30308			
17	8.7.3.01096	1	OIL SEAL	52X85X10			
18	0.291.2000.00	1	SHAFT	1"3/8			
19	0.291.1300.00	1	EXTENSION				
20	8.1.1.00501	8	BOLT	M10X22 8,8			
21	0.286.6000.00	1	PINION	Z17 M5.41			
251	A.291.000 8.6.7.00161	1	OIL FILLER PLUG	3/8G			

ROTOR GEARBOX LF205T

Item No.	Part No (Description	Qty
1	LF135/17	Gear Z22 teeth	1
2	LF135/12	Casing	1
3	LF135/25	Shaft	1
4	LF135/11	Pinion Shaft	1
5	LF135/10	Spacer	1
6	LF135/14	Double Lip Seal	1
7	LF135/4	Protective Washer	1
8	LF135/15	Bearing	1
9	LF135/27	Bearing	1
10	LF135/9	Bearing	2
11	LF135/1	Castle Nut	1
12	LF135/2	Bolt Washer	1
13	LF135/19	Parallel Key	1
14	8.1.10.0054	Bolt	4
15	LF135/6	Snap Ring	1
16	LF135/3	Snap Ring	1
17	8.5.200648	Circlip	1
18	LF135/13	Plug	
19	LF135/5	Double Lip Seal	1
20	357210	Seal	1
21	LF135/26	Cover	1
22	LF135/22	O-Ring	1
23	LF135/8	Shim	1
24	LF135/7	Snap Ring	1
25	N/A	Name Plate	1
26	2.4.8.750000	Shim	1
27	LF135/24	Snap Ring	1
28	LF135/16	Shim	1

WARRANTY PROCEDURE

Steps to take in the event of machine failure

Dealer:

- The warranty claim will be completed by the Major dealer and will be submitted either to head office or to the Major area representative. Any parts replaced under warranty must be tagged and retained until claim is resolved. When ordering replacement spare parts please notify the Major Stores person that this is a warranty claim.
- The Major dealer will sign off on the claim and submit it to Major for consideration.
- The Technical Service Department at Major will study the claim and may request parts to be returned for examination. Major will notify their conclusions to the dealer service person from whom the claim was received.
- Any replacement parts ordered for the machine must be flagged as such when contacting Major. The delivery note and invoice will be flagged with "Warranty Pending" and will be invoiced as normal.
- A warranty claim form will be sent by Major to the dealer for completion. Only when the completed warranty claim form has been received by Major will the claim be resolved.
- Dealers must notify the Major Representative within 10 days of breakdown and all warranty claims are to be settled within 90 days of breakdown notification.

Customer:

Should a Major machine fail due to a defect in material and/or workmanship, the owner should make a warranty claim as follows:

- The machine must be taken to the dealer from where it was purchased or to an authorised Major dealer.
- The owner must present proof of warranty registration.
- The warranty claim will be completed by your Major dealer and will be submitted either to head office or to their Major area representative. Attention: Service Manager: Any parts replaced under warranty must be tagged and retained until claim is resolved.
- The Major dealer will sign off on the claim and submit it to Major for consideration.
- The Technical Service Department at Major will study the claim and may request parts to be returned for examination. Major will notify their conclusions to the dealer service person from whom the claim was received.
- The decision by the Quality/Service department at Major to approve or reject a Warranty claim is final and binding.

NOTE: To process a warranty claim, it is necessary to quote the Model & Serial Number which are printed on the Major Serial Plate – see owners manual

This company warrants its products to be free from defects under the following terms and conditions:

1. Length

All new Major products come with a one season 3 month warranty against defects in materials and workmanship from the original date of purchase from an authorised dealer. Products that have been repaired /replaced will be under warranty for the remainder of the original warranty period or thirty days, whichever is longer.

2. Transferability

The warranty is non-transferable and is only valid for the original owner of the product

WARRANTY PROCEDURE – (cont'd)

3. Coverage

All Major products come with a limited warranty for the period of one year, unless otherwise stated. The warranty solely covers parts and labour of Major products. Major are not liable for products that have been damaged due to abuse or negligence, nor are we liable for incidental or consequential damages. Any normal wear and tear that occurs is not covered under Major's warranty. Consumables such as blades, belts and PTO shafts are not covered under Major's warranty.

The following will result in the warranty being voided

- any product where the serial number has been defaced, modified or removed
- Damage or failure due to abuse, neglect, usage outside of intended purpose & failure to read instructions.
- Unauthorised repairs
- Any non-superficial repairs
- Failure to supply serial number details and/or proof of purchase

The following are not covered under Major's warranty:

- items purchased second hand
- any problem pertaining to cosmetics, unless pre-existing
- failure to determine if the product is right for your intended purposes
- Any incidental or consequential damages that occur to products not made by Major

4. Exclusion of Damages

Major reserves the right to either repair or replace the defective product. Major shall not be held liable to the purchase or any third party for any incidental or consequential damages, including, but not limited to, damages resulting from interruption of service and loss of business. Major is solely responsible for products manufactured by Major and offers no warranties, expressed or implied, for any other products.

TROUBLE SHOOTING

Fault	Cause	Remedy
Leaves a streak of uncut or partially cut grass	Blades dull or bent Carrier RPM too low Field conditions are so wet that the tractor tire is pushing grass into mud Ground speed too fast Grass is down from previous weather conditions Possible build-up materials under mower Blades mounted incorrectly (cutting edge against direction rotation)	Replace blades Use correct PTO speed Too wet to mow. Stop operation and wait until it is drier Reduce ground speed by shifting to a lower gear Mow in only one direction Clean mower Change blades so that cutting edge is facing correct rotation.
Material discharges from mower unevenly; bunches of material along with swath	Material too high and too much material Grass wet	Reduce ground speed but maintain 540rpm at tractor PTO or make two passes over material. Raise mower for the first pass and lower to desired height for the second and cut a 90 degree angle to first pass Allow grass to dry before mowing. Slow ground speed of tractor but keep engine running at full PTO rpm. Cutting lower will help
Gearbox overheating	Low on lubricant Improper type lubricant Excessive grass / debris build-up around gearbox	Fill to proper level Replace with proper lubricant Remove grass, etc from machine
Blade is scalping ground	Mower too low Field is ridged Field is too wet	Raise mower-reset wheels Cut field at a different angle Stop and wait until it is dried

TROUBLE SHOOTING cont.

Fault	Cause	Remedy
Mower will not cut.	Shear bolt sheared	Install new shear bolt
Blades wear too fast	Cutting in sandy conditions Cutting in rocky conditions Blades hitting ground	Increase cutting height Increase cutting height Increase cutting height
Mower seems to require excessive power	Advancing into grass too rapidly Hitting ground Worn or dull blades Tractor not large enough	Reduce forward travel speed Raise mower and reset wheels Sharpen or replace blades Use larger horsepower tractor
Excessive vibration	Check gearbox bolts Check for loose nuts on blades Blade broken New blade or bolts matched with worn blade or bolts Drivelines not phased correctly. Implement and tractor yokes must be in line	Tighten if loose Tighten if loose Replace blades, in set Replace blades or bolts in sets Phase the driveline. Replace if necessary
Noisy machine	Worn bearing Low oil in gearbox Loose Parts Wrong PTO rpm rate Rotors bent / broken Bent PTO shaft	Replace bearings Check level and add oil Check all bolts are fully tightened Check PTO rate & adjust as necessary Replace bent or missing blades Check PTO shafts are aligned correctly Check output shaft on gearboxes are not bent Check driveline between gearboxes is aligned.
Gearbox leaking	Damaged oil seal Bent shaft Shaft rough in oil seal area Oil seal installed incorrectly Oil seal not sealing in the housing Oil level too high Hole in gearbox Gasket damaged Bolts loose	Replace seal Replace oil seal and shaft Replace or repair shaft Replace seal Replace seal or use a sealant on outside diameter of seal Drain oil to proper level Replace the gearbox Replace gasket Tighten bolts

NOTES: