



Operator Manual & Parts List

MAJOR POST DRIVER



Head Office

Major Equipment Intl. Ltd.
Ballyhaunis,
Co. Mayo,
Ireland.

Tel.: +353 (0) 9496 30572
Fax: +353 (0) 9496 30788
Email: info@major-equipment.com

UK Office

Major Equipment Ltd.
Major Industrial Estate,
Middleton Rd.,
Heysham,
Lancs.
LA3 3JJ

Tel.: +44 (0) 1524 850 501
Fax: +44 (0) 1524 850 502
Email: ukinfo@major-equipment.com

NETHERLANDS & GERMANY OFFICE

Major Equipment Intl. Ltd.
Postbus 29,
NL-7700 AA ,
Dedemsvaart,
Nederland.

Tel: +31 (0) 6389 19585
Email: euinfo@major-equipment.com

Web: www.major-equipment.com



Find us on FACEBOOK
MAJOR MACHINERY



View our channel
MAJOREQUIPMENT

Disclaimer

While every effort has been made in the production of this manual to ensure that the information contained herein is full and correct, Major assumes no responsibility for errors or omissions.

Major reserves the right to modify the machinery and the technical data contained within the manual without prior notice.

Further to this, Major assumes no liability for any damages which may result from the use of the information contained within this manual.

Contents

Introduction

Thank you	1
Using Your Operator's Manual	1
Safety Issues	1

Product Identification

Machine Serial Numbers	1
Product Description	1
Product Specifications	1
Register Your Product and Warranty Online	2

Safety

Machine Safety Labels	2
Operating Safely	3
Driving Safely on Public Roads	3
Safe Storage of the Machine	4

Operating the Machine

Inspections before Use	4
Key to Main Parts	4
Pre-Use Assembly	5
Spool Controls	5
Hitching to the Tractor	6
Operating the Machine	6
Finishing and Moving Away	6

Spare Parts

Post Driver Overview	7
Post Driver Hydraulic Hoses	9

EEC certificate of conformity for machines

(conforming to Directive 98/37/EEC)

Company: Major Equipment Ltd.
Address: Coolnaha,
Ballyhaunis,
Co. Mayo,
Ireland.
Tel. +353949630572
Fax +353949630788

declares in sole responsibility that the product:

POST DRIVER

When properly installed, maintained and used only for it's intended purpose, complies with all the essential Health & Safety requirements of:

- **THE SUPPLY OF MACHINERY (SAFETY) REGULATIONS 2008.**
- **S.I. No. 299 of 2007**, Safety, Health and Welfare at Work (General Application) Regulations 2007 **(Ireland)**.
- **Health & Safety at Work, etc. Act 1974 (c.37) (UK)**.
- **EN ISO 14121-1: 2007** 'Safety of machinery. Principles for risk assessment'.
- **EN ISO 13857** - Safety of machinery: Safety distances to prevent hazard zones being reached by upper and lower limbs.

I certify on behalf of Major Equipment Int. Ltd., that this machine when properly installed and operated correctly, complies with all the essential Health & Safety requirements of all legislation referred to above.



Signature : _____
Managing Director

Date 12/01/2012

Introduction

Thank you

We appreciate having you as a customer and wish you many years of safe and satisfied use of your machine.

Using Your Operator's Manual

This manual is an important part of your machine and should remain with the machine when you buy it. Reading your operator's manual will help you and others avoid personal injury or damage to the machine. Information given in this manual will provide the operator with the safest and most effective use of the machine.

Sections in your operator's manual are placed in a specific order to help you understand all the safety messages so you can operate this machine safely. You can also use this manual to answer any specific operating or servicing questions.

Safety Issues

Your manual contains special messages to bring attention to potential safety concerns, machine damage as well as helpful operating and servicing information. Please read all the information carefully to avoid injury and machine damage.

Product Identification

Machine Serial Numbers

If you need to contact MAJOR or your MAJOR dealer for information on servicing or spare parts, always provide the product model and serial numbers.

We suggest that you record your machine details below:

Model No: _____

Serial No: _____

Date of Purchase: _____

Dealer Name: _____

Dealer Telephone: _____

Product Description

The MAJOR Post Driver is an attachment for tractors. The driver (weight box) is raised hydraulically and then released in a free fall. Do not risk injury or death by ignoring good safety practices. All accidents can be avoided.

Product Specifications

Mass	Circa 800 kg
Hammer weight	350 kg
Width	106 cm
Height	300 cm
Length	80 cm
Height Hammer raised	410 cm
Attachment to tractor	3 point linkage
Hydraulic connections	¾" male q/r
Grease points	8 + slider
Post size	Max 11' x 12 "

Rope Specification:

Description: 28mm 3 strand White Nylon Rope

Minimum Breaking Load: 15.8 Tonne

Specification: To BSEN 696 : 1995

Register Your Product and Warranty Online

To register your product through the Internet, simply go to the Support section on www.major-equipment.com. Completing the information, either online or with the product warranty card, will ensure the customer that their product receives all post sales service and important product information.

Safety

Machine Safety Labels

The machine safety labels shown in this section are placed in important areas on your machine to draw attention to potential safety hazards.

On your machine safety labels, the words DANGER, WARNING, and CAUTION are used with this safety-alert symbol. DANGER identifies the most serious hazards.



The operator's manual also explains any potential safety hazards whenever necessary in special safety messages that are identified with the word, CAUTION, and the safety-alert symbol.

The Major Post Driver comes equipped with all safety labels in place. They are intended to help you operate your machine safely.

1. Read and follow the safety label directions.
2. Keep safety labels clean and legible.
3. Replace damaged or missing safety labels.

To prevent Serious Injury or Death

- Avoid unsafe operation or maintenance.
- Do not operate or work on this machine without reading and understanding the operator's manual.
- If manual is lost, contact your nearest dealer for a new manual.



Read the Manual:

Thoroughly read and understand the manual

WARNING



DO NOT GO NEAR LEAKS

- High pressure oil easily punctures skin causing serious injury, gangrene or death.
- If injured, seek emergency medical help. Immediate surgery is required to remove oil.
- Do not use finger or skin to check for leaks.
- Lower load or relieve hydraulic pressure before loosening fittings.

High oil pressure hazard

DANGER

CRUSH HAZARD



DO NOT PLACE HAND ON TOP OF POST WHEN LOCATING STRIKE PLATE

CRUSH INJURY - Keep hands clear of the strike plate and top of the post when operating the machine.

IMPORTANT

THIS MACHINE IS NOT SUPPLIED WITH A HYDRAULIC TOP LINK.

IF FITTING A HYDRAULIC TOP LINK, ENSURE IT IS FITTED WITH FLOW RESTRICTORS AS TO REDUCE SPEED OF THE MACHINE TIPPING FRONT TO BACK.

THIS IS TO REDUCE RISK OF INJURY

CONSULT YOUR DEALER OR MANUFACTURER FOR MORE INFORMATION

Hydraulic top link hazard



EAR AND EYE PROTECTION MUST BE WORN DURING OPERATION

Ear and eye protection must be worn during operation

Crush Injury: keep hands clear of the strike plate and weight box when operating. Keep guarding in place

STRIKE AREA

KEEP POST TO BACK PLATE



Post location: ensure that the post os on the strike plate

TOP LINK	TILT	DRIVER (WEIGHT BOX)
FWD ↕ BACK	RIGHT ↕ LEFT	DOWN ↕ UP

Spool instructions

Operating Safely

- Never put hands or fingers between hammer plate or post
- Never stand directly in front of Post Driver while operating. Stand at 45° to machine in case post is pushed outwards during hammer action.
- The operator should be wearing long sleeve shirt, long legged pants, hearing and eye protection, hard hat, steel-toe capped boots and gloves
- Any other persons who are working nearby, must also wear hearing protection

Users should become thoroughly familiar with the contents of this manual before using, servicing and mounting the implement to the tractor and all other pertinent operations.

Never wear jewellery, loose clothing such as ties, scarves, belts, unbuttoned jackets or dungarees with open zips which could become caught up in moving parts. Always wear approved garments complying with accident prevention provisions such as non-slip shoes, ear muffs, goggles and gauntlets. Wear a jacket with reflecting stickers if the implement is used near public highways.

Consult your retailer, the Labour Health Service or your nearest equivalent authority for information about the current safety provisions and specific regulations to comply with in order to ensure personal safety

Do's

- ALWAYS use genuine MAJOR parts for best results.
- ALWAYS use suitable tools for the job.
- ALWAYS work in good, safe working conditions.
- ALWAYS use safety equipment.

Don'ts

- NEVER leave weight box suspended for periods of time
- NEVER leave an unproped body unattended.
- NEVER work without supervision.



Major Equipment International Limited requires that anyone operating or maintaining the MAJOR Post Driver read and understand all safety, operation and maintenance data contained in this manual.

IMPORTANT

Never operate freefall mechanism without a post under hammer plate or excessive strain to the machine will occur.

The MAJOR Post Driver is an attachment for tractors. The driver (weight box) is raised hydraulically and then released in a free fall. Never operate the post driver if unauthorised persons are in the area. Cease operations if unauthorised people approach and inform them of the potential hazards so they understand why you will not continue they leave the area.

Hazards associated with post driving may be

- Crush injuries.
- Hydraulic oil leaks
- Noise exposure,
- Eye injury or facial injury by splinters,
- Trip/slip/falls depending on ground conditions & housekeeping,
- Overhead electrical contact,
- Underground utility or Electrical contact

Do not risk injury or death by ignoring good safety practices. All accidents can be avoided.

Driving Safely on Public Roads

- Ensure you are in compliance with all local regulations regarding transporting equipment on public roads and highways
- Ensure that the machine is securely attached to the tractor
- Ensure Weight Box is at lowest part of beam when in transport.
- Be aware of any height restrictions on route i.e. overhead cables etc.

Safe Storage of the Machine

- Make sure the unit is sitting firm and solid and will not tip over
- Brace angle adjustment ram (tilt Ram)
- Rest weight and post cap on a post driven into the ground when storing for long periods

Operating the Machine

Inspections before Use

- Grease every 20 hours of operation and pre/post season
- Ensure tractor is of sufficient weight to be stable with Post Driver
- Ensure that the Post Driver is properly attached to the tractors three point linkage
- Check that all hydraulic fittings are tight
- Check rope is in good condition & replace with correct type when wear is detected.
- Check that guarding is present & not damaged.
- Check for damaged, worn, missing parts and replace if necessary
- Check safety labels are in place on beam and hammer and that they are clean and legible. Replace if necessary

Key to Main Parts

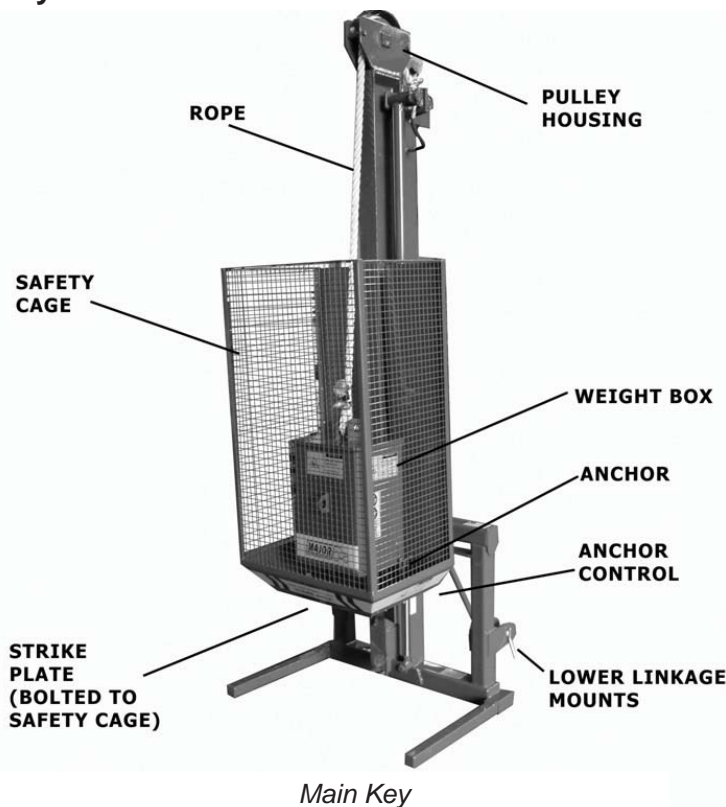

Main Key - Guarding removed for clarity

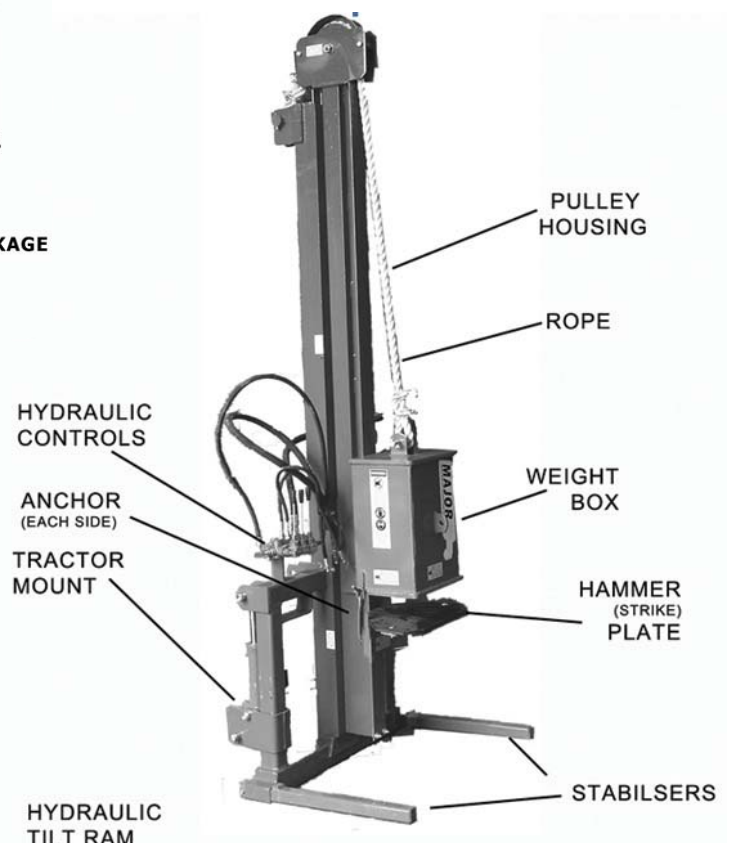

Pre-Use Assembly



Important: The spool bank must be relocated and bolted into “working position” use” position prior to operation.

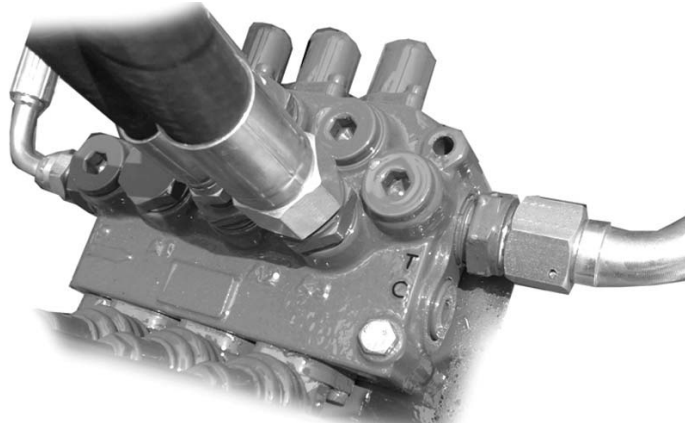
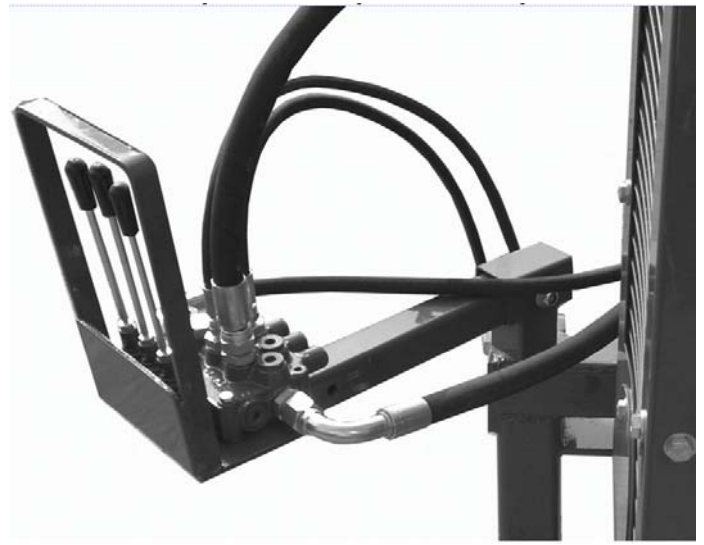
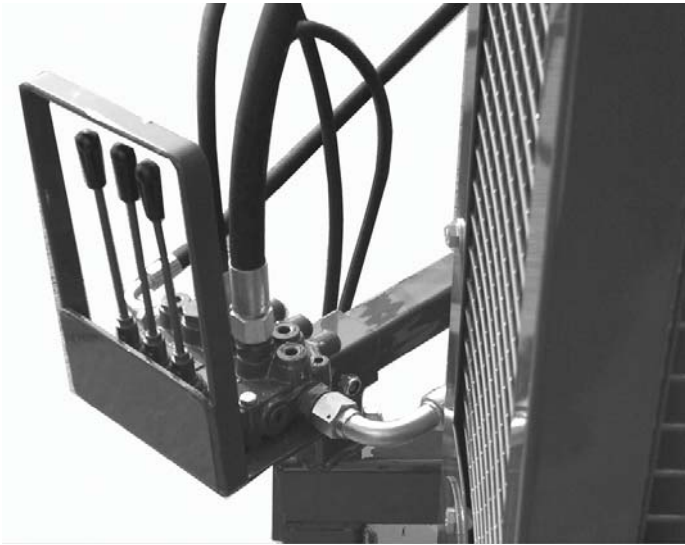

Closed Centre Hydraulics: NOTE: If tractor hydraulics are closed center type, the spool must be altered to suit by:

- Remove the bung located beside the return hose (marked 'c')
- Remove the 3/4" Return hose from the port marked 'T'
- Fit the Return hose in the threaded port marked 'C'
- Use the Bung to Block the port marked 'C'

Spool Controls



Use the spool controls smoothly. The weight box drops quickly with only a small adjustment on the spool.

Spool Levers:

TOP LINK	TILT	DRIVER (WEIGHT BOX)
FWD ↕ BACK	RIGHT ↕ LEFT	DOWN ↕ UP

Operation with Hydraulic Top Link

If the operator connects a hydraulic top link operator must aware of the quick action of the machine tipping forward.

NOTE: This machine is not fitted with an hydraulic top link. If fitting a hydraulic top link ensure it is fitted with flow restrictors as to reduce the speed of the machine tipping forward. Consult your dealer or manufacturer for more information.



Hitching to the Tractor



You are responsible for safe operation and maintenance of the Post Driver. The most important safety device on the equipment is a safe operator.

NOTE: always operate on level ground when hitching/unhitching the implement. This will prevent dangerous movement. Never allow anyone to stand between the tractor and the machine.

1. Adjust both lift arms of the tractor until they are level in relation to each other.
2. Hitch the lower linkage arms to the machine and connect the top link and PTO shaft. Ensure that the locking pins are secure.
3. With the machine lowered in its operating position, adjust the top link until the main frame is vertical.

Operating the Machine



WARNING: Stand at 45° to hammer weight: not in front, as post may splinter or burst forward.

NOTE: For posts of small cross-section it may be necessary to limit the height the hammer is dropped from to prevent the post breaking up under impact load

1. Position the tractor and the Post Driver at location where post is to be driven
2. Apply brake securely and put transmission into park/neutral
3. Lower Post Driver to the ground with tractor link arms. Ensure stabilisers are in place unless operating near ground obstacle which requires removal of stabiliser. Use extreme care when operating under such conditions and re-attach stabiliser as soon as possible. Side-tilt: On even ground adjust tilt ram such that the Post Driver sits firmly on the ground.
4. Be aware of height restrictions e.g. overhanging trees, overhead cables, etc.
5. Operate main ram to lift hammer and plate above height of post
6. Position the post, if the posts are not square on top of the hammer plate, please make sure that the highest point of the post is centred and up against the beam.
7. Lower hammer and plate onto post and unhook chains attached to weight box



Stop driving if post encounters an impassable object, or if it begins to crack, or top begins to mushroom. Consider a pilot hole if ground conditions create the post driving conditions mentioned.

8. Lift hammer a short distance, then drop by pushing lever to max lower position. Repeat short strokes to start post. Once the post has started, the hammer should be raised no more than two feet and dropped
9. Repeat until post is at required height

Finishing and Moving Away

1. Hook anchors onto hammer and lift strike plate off driver (weight box) using hydraulic control.
2. Lift the Post Driver off ground with tractor link arms and move away from post such that the hammer can be lowered before moving to the next location.



Note:

The hammer weighs 350 kg and must be kept near the bottom of the beam at all times while the tractor is in motion.

Spare Parts

Post Driver Overview

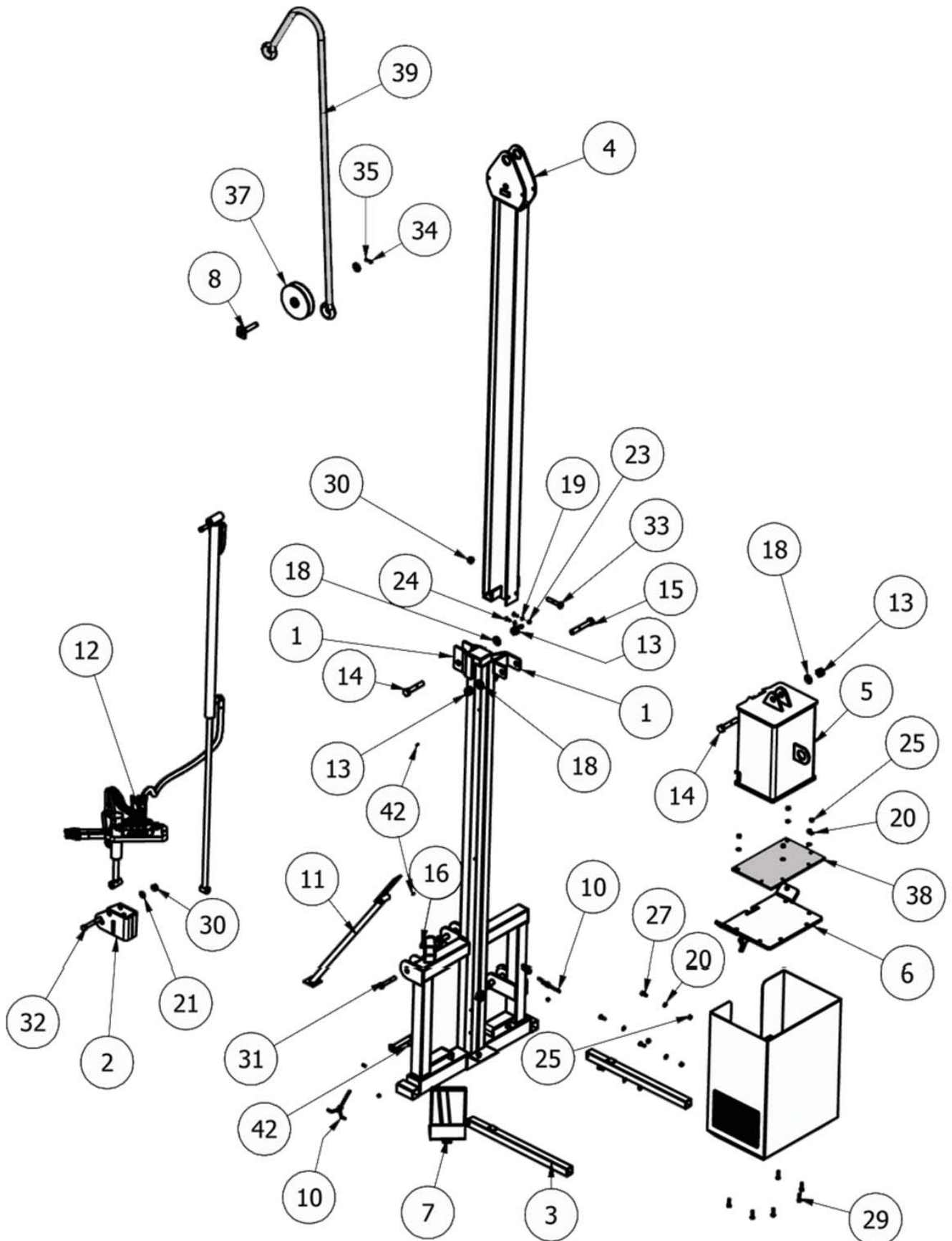

Post Driver Parts List

Item	Part No	Description	Item	Part No	Description
1	PD-0001	Main Welded Asm PD	23	M10	M10 NYLOC NUT
2	PD-0017	Sliding Lower Linkage	24	M10x25SZP	M10x25 SET BOLT
3	PD-0024	STAND LEGS	25	M12	M12 NYLOC NUT
4	PD-0026	MAST ASM	26	M12HEX	M12 PLAIN NUT
5	PD-0028	HAMMER ASM	27	M12x30SZP	M12x30 SET BOLT
6	PD-0042	POST BACKING PLATE ASM	28	M12x35BZP	M12x35 BOLT
7	PD-0053	SPOOL CONTROL BRACKET	29	M12x40BZP	M12x40 BOLT
8	PD-0061	TOP PULLEY PIN ASM	30	M20	M20 NYLOC NUT
9	PD-0073	HAMMER GUARD	31	M20x110BZP	M20x110 BOLT
10	PD-0084	HAMMER TRANS PIN	32	M20x130BZP	M20x130 BOLT
11	PD-0089	SAFETY STAND LEG	33	M20x90BZP	M20x90 BOLT
12	PD-HYD-ASM	FULL HYDRAULIC ASM PD	34	M8	M8 NYLOC NUT
13	1F	1" FINE NYLOC NUT	35	M8x40BZP	M8x40 BOLT
14	1x5FBZP	1"x5" FINE BOLT	36	M8x60BZP	M8x60 BOLT
15	1x6FBZP	1"x6" FINE BOLT	37	PD-0058	Pulley Post Driver
16	272	SHAFT LOCK PIN DIA 11	38	PD-0062	RUBBER BUFFER (HAMMER)
17	54779	EYE NUT M8 COARSE	39	PD-ROPE	HAMMER ROPE
18	FW1	DIA 1" FLAT WASHER	40	S37	LINCH PIN DIA 6
19	FWM10	M10 FLAT WASHER	41	S80	CAT 2 PIN DIA 25.4x142mm
20	FWM12	M12 FLAT WASHER	42	S849	GREASE NIPPLE M6 STR
21	FWM20	M20 FLAT WASHER	43	12T-BBS	BLADE BACK SPACER
22	FWM8	M8 FLAT WASHER			

Post Driver Hydraulic Hoses

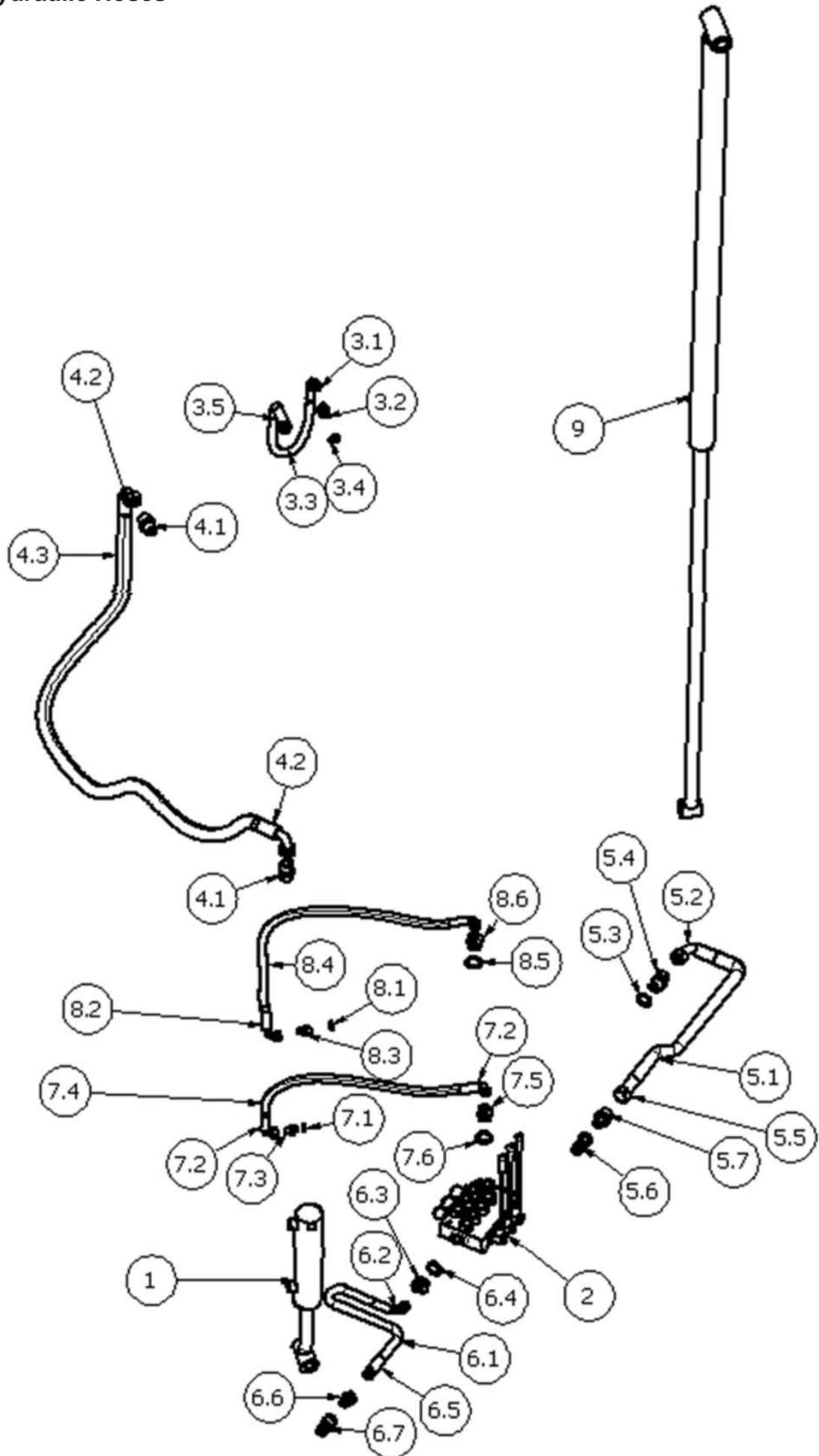

Post Driver Hydraulic Hoses Parts List

Item	Part No	Description	Item	Part No	Description
2	ML-3-A1	3 bank mono-bloc da/da/sa	6.3	EMM3438	3/4"-3/8 M/M CONNECTOR
3	PD-0082	3/8" Breather Pipe Asm	6.4	EDOW34	3/4" DOWTY WASHER
3.1	CRP3890	3/8" CRIMP (90 Deg)	6.5	CRP3800	3/8" CRIMP (STRAIGHT)
3.2	EMM38	3/8" M/M CONNECTOR	6.6	EMM3812	1/2-3/8" M/M CONNECTOR
3.3	PD-0081	3/8" x250mm Hyd Hose	6.7	QRM12	1/2" QUICK RELEASE MALE
3.4	EDOW38	3/8" DOWTY WASHER	7	PD-HYD-01	3x8" x HYD HOSING ASM
3.5	CRP3800	3/8" CRIMP (STRAIGHT)	7.1	EDOW14	1/4" DOWTY WASHER
4	PD-HYD	3/4" Ram Feed Hose ASM	7.2	CRP1490	1/4" CRIMP (90 Deg)
4.1	EMM34	3/4" M/M CONNECTOR	7.3	EMM14	1/4" M/M CONNECTOR
4.2	CRP3490	3/4" CRIMP (90 Deg)	7.4	PD-0070	3/8" x 850mm HOSE
4.3	PD-HYD-001	3/4" x 1200mm PIPE	7.5	EMM3414	3/4-1/4" M/M CONNECTOR
5	PD-HYD-003	3/4" HYD SEND HOSE	7.6	EDOW34	3/4" DOWTY WASHER
5.1	PD-HYD-002	3/4" x 1600mm HYD HOSE	8	PD-HYD-02	3/8" HYD HOSE ASM
5.2	CRP3490	3/4" CRIMP (90 Deg)	8.1	EDOW14	1/4" DOWTY WASHER
5.3	EDOW34	3/4" DOWTY WASHER	8.2	CRP1490	1/4" CRIMP (90 Deg)
5.4	EMM34	3/4" M/M CONNECTOR	8.3	EMM14	1/4" M/M CONNECTOR
5.5	CRP3400	3/4" CRIMP (STRAIGHT)	8.4	PD-0069	3/8" x 850mm HOSE
5.6	QRM12	1/2" QUICK RELEASE MALE	8.5	EDOW34	3/4" DOWTY WASHER
5.7	EMM1234	1/2-3/4" M/M CONNECTOR	8.6	EMM3414	3/4-1/4" M/M CONNECTOR
6	PD-HYD-005	3/8" RETURN HYD HOSE	9	PD-MAST-RAM-ASM	PD-MAST-RAM ASM
6.1	PD-HYD-004	3/8" x 1600mm HOSE			
6.2	CRP3890	3/8" CRIMP (90 Deg)			

Warranty: This machine is guaranteed for 12 months. No warranty is given where the machine is being used as a hire machine. Warranty is against faulty workmanship or parts, with the exception of components not of MAJOR'S manufacture or design, i.e. hydraulic components, universally jointed shafts, chains and tyres, etc., which are subject to the original manufacturers conditions. To register your machine for warranty, please go to the support section of our website www.major-equipment.com and enter your details.

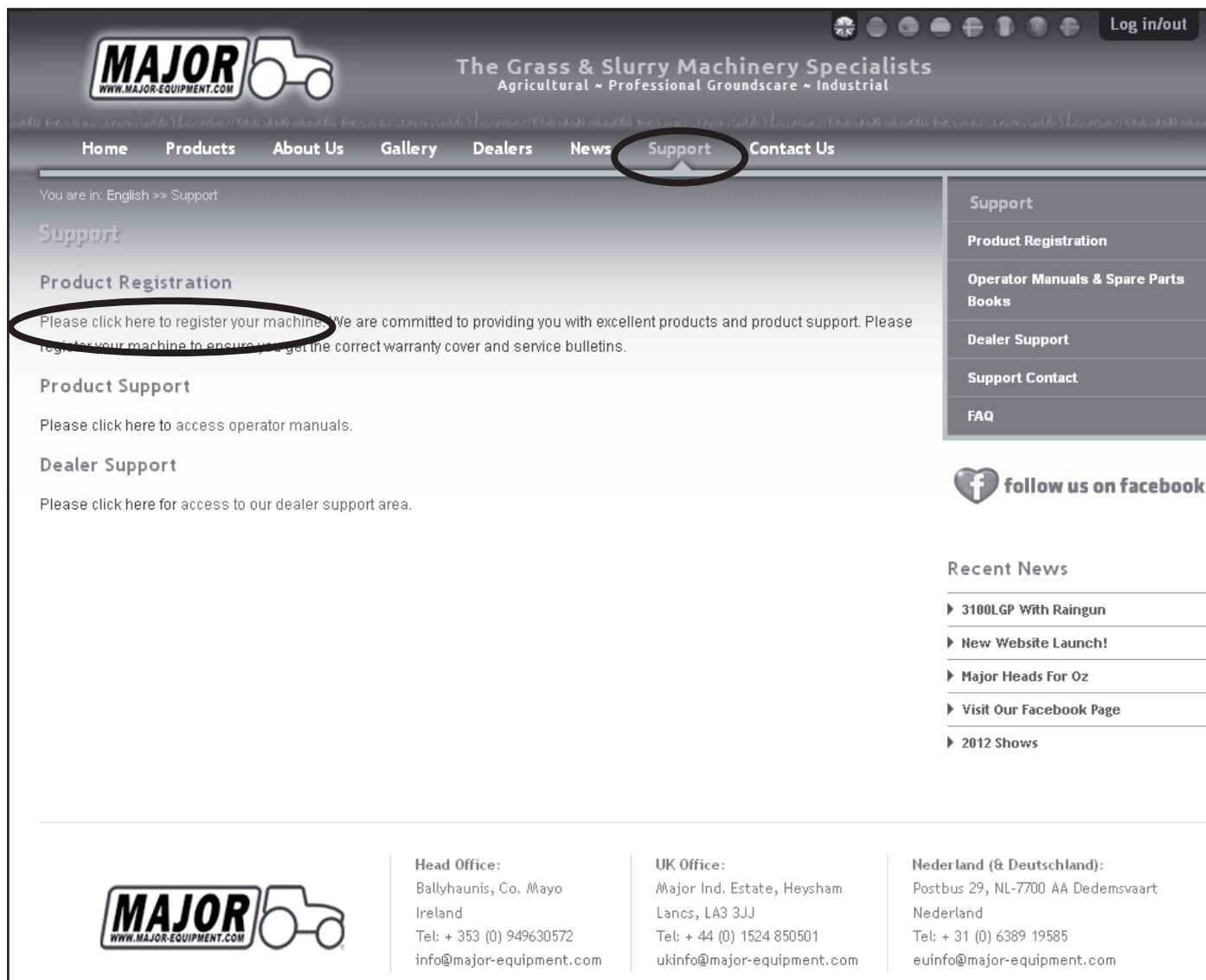

MAJOR
WWW.MAJOR-EQUIPMENT.COM

The Grass & Slurry Machinery Specialists
Agricultural ~ Professional Groundscare ~ Industrial

Home Products About Us Gallery Dealers News **Support** Contact Us

You are in: English >> Support

Support

Product Registration

Please click here to register your machine. We are committed to providing you with excellent products and product support. Please register your machine to ensure you get the correct warranty cover and service bulletins.

Product Support

Please click here to access operator manuals.

Dealer Support

Please click here for access to our dealer support area.

Support

- Product Registration
- Operator Manuals & Spare Parts Books
- Dealer Support
- Support Contact
- FAQ

 follow us on facebook

Recent News

- ▶ 3100LGP With Raingun
- ▶ New Website Launch!
- ▶ Major Heads For Oz
- ▶ Visit Our Facebook Page
- ▶ 2012 Shows

MAJOR
WWW.MAJOR-EQUIPMENT.COM

Head Office:
Ballyhaunis, Co. Mayo
Ireland
Tel: + 353 (0) 949630572
info@major-equipment.com

UK Office:
Major Ind. Estate, Heysham
Lancs, LA3 3JJ
Tel: + 44 (0) 1524 850501
ukinfo@major-equipment.com

Nederland (& Deutschland):
Postbus 29, NL-7700 AA Dedemsvaart
Nederland
Tel: + 31 (0) 6389 19585
euinfo@major-equipment.com



HEAD OFFICE

Major Equipment Intl Ltd
Ballyhaunis, Co Mayo
Ireland
Tel: +353 (0) 9496 30572

UK OFFICE

Major Equipment Ltd
Major Ind. Estate, Heysham,
Lancs, LA3 3JJ, UK
Tel: +44 (0) 1524 850501

Netherlands & Germany OFFICE

Major Equipment Intl Ltd
Postbus 29, NL-7700 AA
Dedemsvaart, Nederland
Tel: + 31 (0) 6389 19585